



Powell Road, E5

£400,000

A one-bedroom garden flat in a lower ground three-storey Victorian building. The property features a double bedroom, a modern bathroom, a fitted kitchen, and a separate reception room. With over 450 sq foot of internal space this property is also situated on a quiet residential street in Clapton.

It is located within walking distance of Clapton Overground Station, providing easy access to the City and West End, and is close to a range of local amenities along Lower Clapton Road and Chatsworth Road.

Features

Offers in Excess of
One Double Bedroom
Period Conversion
Patio Included
Residential Street
Private entrance
Hackney Downs Park

Powell Road, London, E5

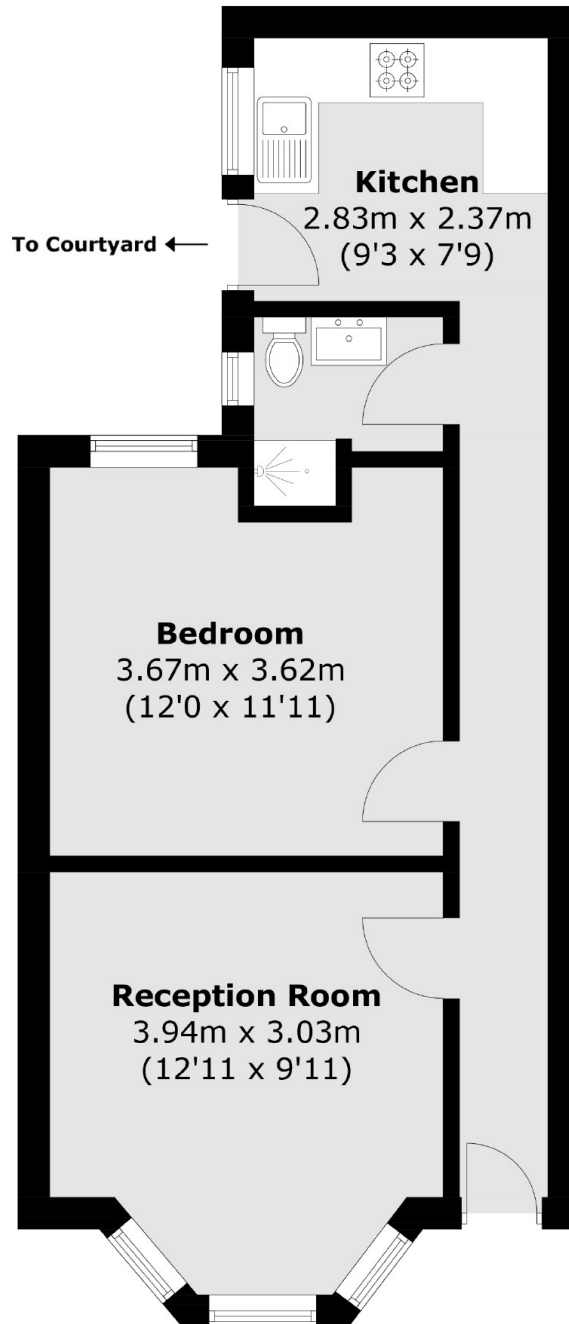

Total area (approx.): 42.6 sq. m (458.5 sq. ft)

Dexters

Hackney Central
331 Mare Street
Hackney
London
Sales
020 7067 2420

Energy Rating: . We aim to make our particulars both accurate and reliable. However they are not guaranteed; nor do they form part of an offer or contract. If you require clarification on any points then please contact us, especially if you're traveling some distance to view. Please note that appliances and heating systems have not been tested and therefore no warranties can be given as to their good working order.

 **RICS** | Regulated
Estate Agent
and Letting Agent

[dexters.co.uk](https://www.dexters.co.uk)