



Roding Road, E5

£325,000

A one double bedroom flat located within a gated development in Lower Clapton. The property has an open plan kitchen/living room, modern bathroom, wooden flooring and long lease. The property further benefits from a spacious hallway, currently setup as a suitable home-working space, along with plenty of storage. It is being sold chain free and with secure bike storage.

Roding Road is within walking distance to the Hackney Marshes, Mabley Green and the River Lea offering many opportunities for outdoor recreation as well as the popular Chatsworth Road with its many cafes, restaurants, shops and Sunday Market. Homerton Overground is less than half a mile with direct trains into the transport hub Stratford & Stratford International and into West London.

Features

Offers Over
One Double Bedroom + Office Area
Gated Development
Chain Free
Chatsworth Road
Hackney Marshes
Open Plan

Roding Road, London, E5

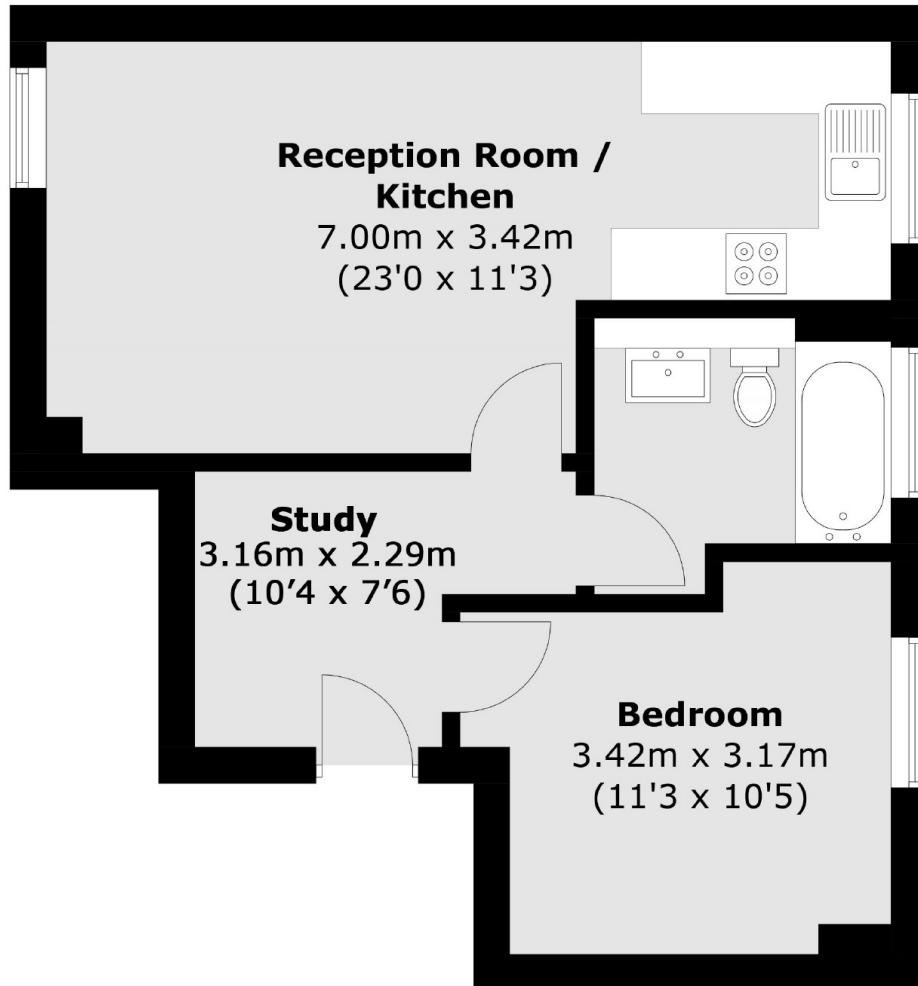

Total area (approx.): 43.5 sq. m (468.2 sq. ft)