



## Atkins Square, E8

### £475,000

An immaculate one bedroom on the top floor of the award winning Atkins Square development with amazing city views. This well proportioned property has a large open plan reception with full length balcony, excellent energy efficiency and is being sold chain free. The building has a concierge and residents gym.

Centrally located on Dalston Lane, the apartment is surrounded by an abundance of popular restaurants, shops and bars on Mare Street, Broadway Market and Lower Clapton Road. The green spaces of Hackney Downs Park and London Fields are also within walking distance with tennis courts and Lido. Transport links include Hackney Downs just 150m away with direct trains to Liverpool Street, and Hackney Central a quarter of a mile away for easy access to Central London and Stratford.

### Features

- One Double Bedroom
- Private Balcony
- City Views
- Top Floor
- Gym & Concierge
- Secure Development
- Lift Access

# Atkins Square, London, E8

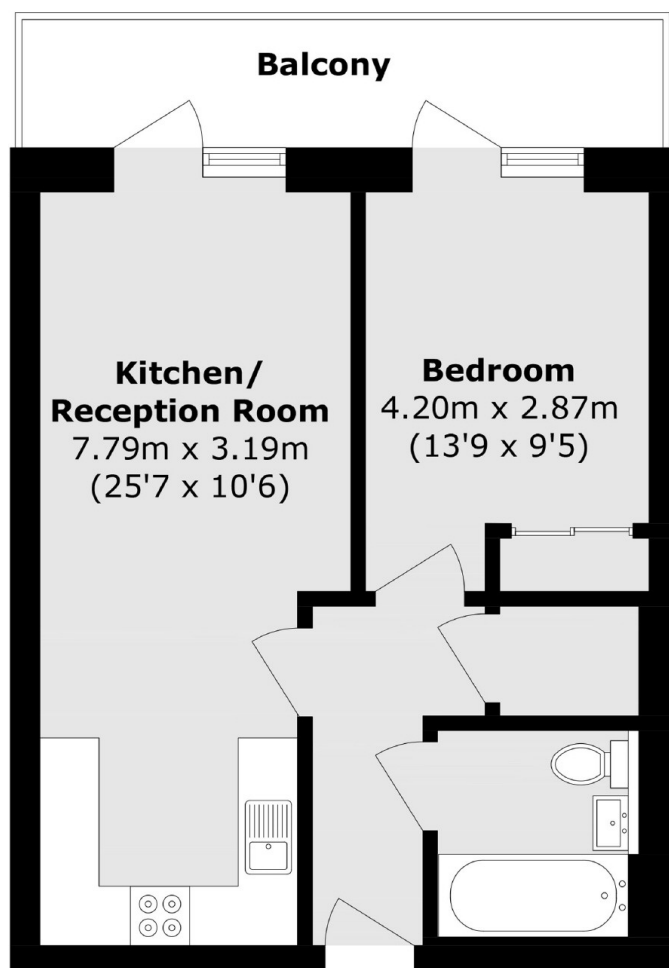

Total area (approx.): 48.0 sq. m (516.7 sq. ft)

Balcony area (approx.): 8.4 sq. m (90.4 sq. ft)