



**Fassett Road, E8**

**£1,250,000**

**Dexters**



## Fassett Road, E8

A beautifully presented three bedroom Victorian maisonette with a south facing private terrace and garden. Set over three storeys the home has its own private entrance, impressively high ceilings, double reception and loft extension. Entering above street level the raised ground floor has a large reception & dining room with feature fireplace, sash bay window. To the rear is the kitchen with breakfast bar and double doors leading to the terrace overlooking the south facing garden with decking. There is also a separate W/C. On the first floor is the larger than average bathroom with double vanity, free standing tub, walk in shower and a built-in utility room, double bedroom and primary bedroom to the front of the house with a raised butterfly ceiling and skylights. On the top floor is another double bedroom with skylight.

Entering above street level the raised ground floor has a large reception & dining room with feature fireplace, sash bay window. To the rear is the kitchen with breakfast bar and double doors leading to the terrace overlooking the south facing garden with decking. There is also a separate W/C.

On the first floor is the larger than average bathroom with double vanity, free standing tub, walk in shower and a built-in utility room, double bedroom and primary bedroom to the front of the house with a raised butterfly ceiling and skylights. On the top floor is another double bedroom with skylight.

### Features

- Three Double Bedrooms
- Maisonette
- Victorian Conversion
- South Facing Terrace & Garden
- Freehold
- London Fields











# Fassett Road, London, E8

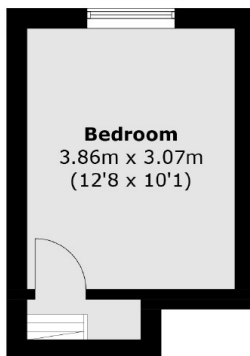

**Second Floor**



**Upper Ground Floor**

**First Floor**

Total area (approx.): 121.1 sq. m (1,303.5 sq. ft)