



Sylvester Path, E8

A two double bedroom period conversion that has been recently renovated on the cobblestone street Sylvester Path. The property is over 750 sq ft and benefits from high ceilings, separate kitchen, its own private entrance and a new long lease. It is being sold chain free.

Sylvester Path is a pedestrian only street 150 yards from Hackney Central and Hackney Downs Overground Stations offering excellent transport links across the City. There is a variety of high street shops, cafes and restaurants on your doorstep and the famous Hackney Empire and Town Hall are only 100 yards. London Fields Park & Lido and weekend market are also half a mile away.

Features

- Offers Over
- Two Double Bedrooms
- Recently Renovated
- London Fields
- Period Conversion
- Over 750 sq ft
- Chain Free

Sylvester Path, London, E8

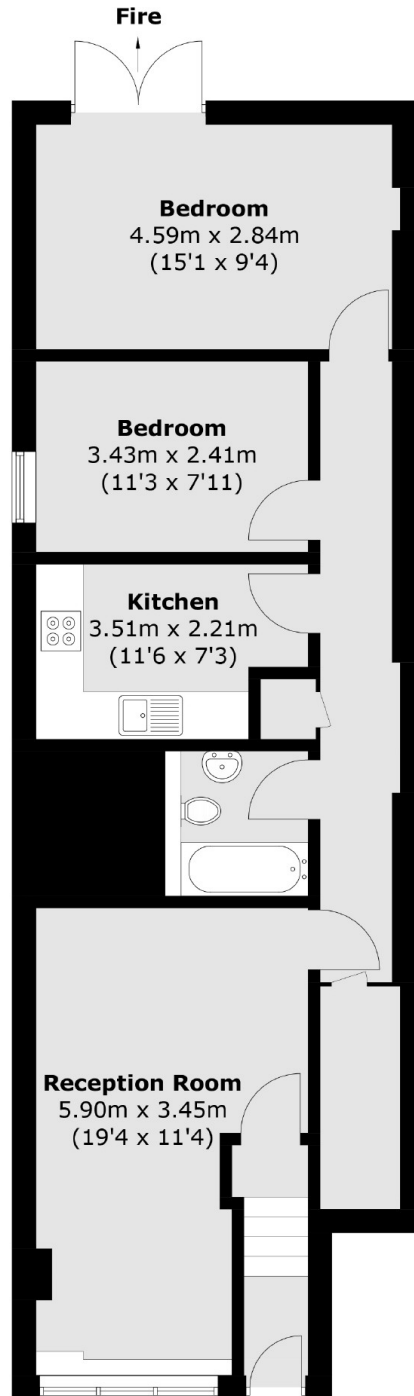

Total area (approx.): 70.4 sq. m (757.7 sq. ft)

Dexters

Hackney Central
331 Mare Street
Hackney
London
Sales
020 7067 2420

Energy Rating: TBC. We aim to make our particulars both accurate and reliable. However they are not guaranteed; nor do they form part of an offer or contract. If you require clarification on any points then please contact us, especially if you're traveling some distance to view. Please note that appliances and heating systems have not been tested and therefore no warranties can be given as to their good working order.

 **RICS** | Regulated
Estate Agent
and Letting Agent

[dexters.co.uk](https://www.dexters.co.uk)