



Lea Bridge Road, E5

£400,000

A modern one double bedroom flat located within a contemporary riverside development. Measuring over 560 sq ft the property has a spacious open plan kitchen living area with floor to ceiling windows, balcony with park views, plenty of storage and communal gardens.

Paradise Park is surrounded by the green spaces of Millfields Park, the Hackney Marshes and the River Lea. Clapton Overground Station is half a mile away offering direct access into the transport hub Liverpool Street. The many restaurants, cafes, shops and Sunday Market on Chatsworth Road is within walking distance only half a mile away.

Features

- Offers Over
- One Double Bedroom
- Heating and Hot Water Included in Service Charge
- Balcony
- Over 569 sq ft
- Millfields Park
- Communal Gardens

Lea Bridge Road, London, E5

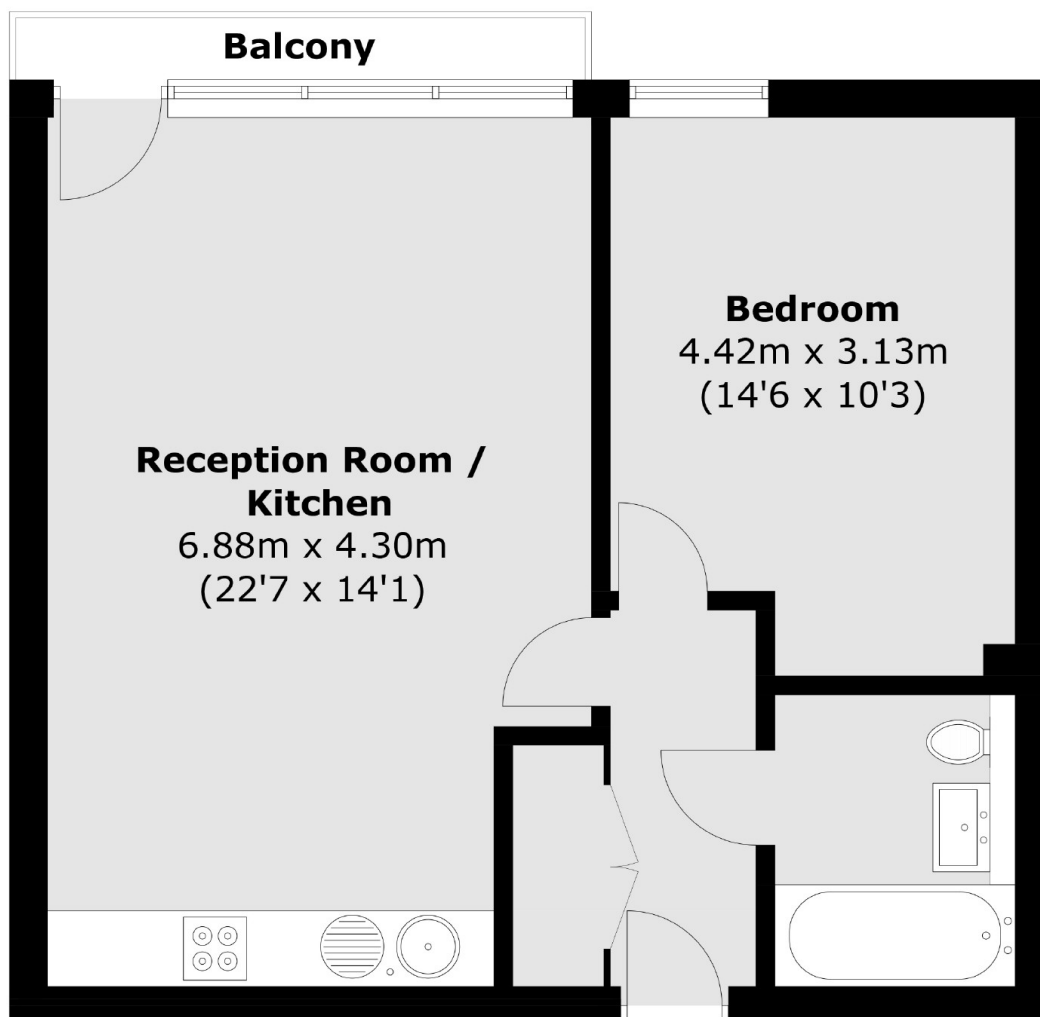

Total area (approx.): 52.9 sq. m (569.4 sq. ft)
Balcony: 2.2 sq. m (23.7 sq. ft)

Dexters

Hackney Central
331 Mare Street
Hackney
London
Sales
020 7067 2420

Energy Rating: C. We aim to make our particulars both accurate and reliable. However they are not guaranteed; nor do they form part of an offer or contract. If you require clarification on any points then please contact us, especially if you're traveling some distance to view. Please note that appliances and heating systems have not been tested and therefore no warranties can be given as to their good working order.

 **RICS** | Regulated
Estate Agent
and Letting Agent

[dexters.co.uk](https://www.dexters.co.uk)