

Spurstowe Terrace, E8

£500,000

A two bedroom, two bathroom apartment in a modern secure development, Portcullis House. The property benefits from an open plan kitchen living area with private balcony, principal bedroom with en-suite, lift access and no onward chain.

Just around the corner from both Hackney Central and Hackney Downs Overground stations offering direct access to the City. Set in the heart of Hackney, this property is a short walk from the many shops, bars, restaurants, cafés of Hackney Central and Broadway Market. The green spaces of London Fields and Hackney Downs Park are under half a mile away.

Features

- Two Bedrooms
- Two Bathrooms
- Private Balcony
- Over 680 sq ft
- Lift Access
- Hackney Downs
- Chain Free

Spurstowe Terrace, London, E8

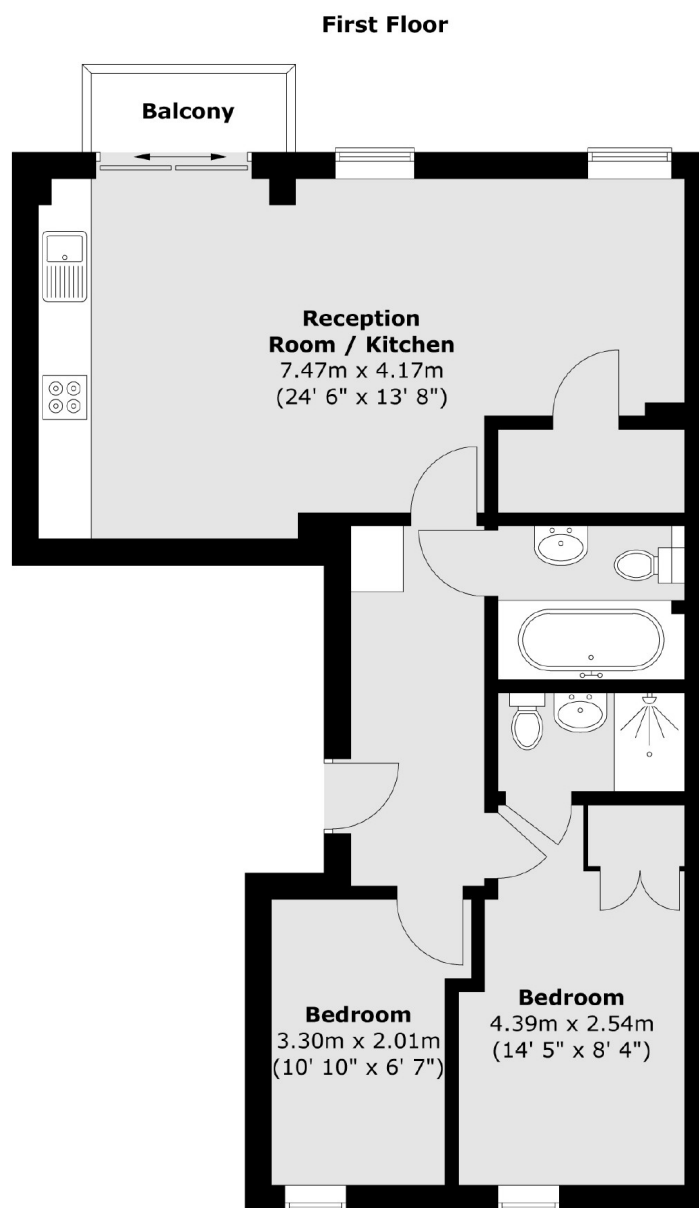

Total area (approx.) : 63.5 sq. m (683 sq. ft)
Total balcony area (approx.) : 2 sq. m (22 sq. ft)

Dexters

Hackney Central
331 Mare Street
Hackney
London
Sales
020 7067 2420

Energy Rating: C. We aim to make our particulars both accurate and reliable. However they are not guaranteed; nor do they form part of an offer or contract. If you require clarification on any points then please contact us, especially if you're traveling some distance to view. Please note that appliances and heating systems have not been tested and therefore no warranties can be given as to their good working order.

 **RICS** | Regulated
Estate Agent
and Letting Agent

[dexters.co.uk](https://www.dexters.co.uk)