



## Homerton High Street, E9

£825,000

A four double bedroom home within close proximity to Victoria Park and Chatsworth Road. The home measures over 1600 sq ft and has potential to extend into the loft, subject to planning. It benefits from having a double reception room, wooden floors, bay window, private garden and two bathrooms. Transport and amenities are right on your doorstep.

Homerton High Street & Chatsworth Road offers an abundance of local restaurants, shops and a Sunday market. Victoria Park, Mare Street and Broadway Market are a short cycle away, and Homerton Overground is a quarter of a mile away offering direct access to Stratford and the Elizabeth Line.

### Features

- Four Double Bedrooms
- Two Bathrooms
- Victorian Terrace
- Garden
- Rear Extension
- Chatsworth Road
- Loft & Side Return Potential

# Homerton High Street, London, E9

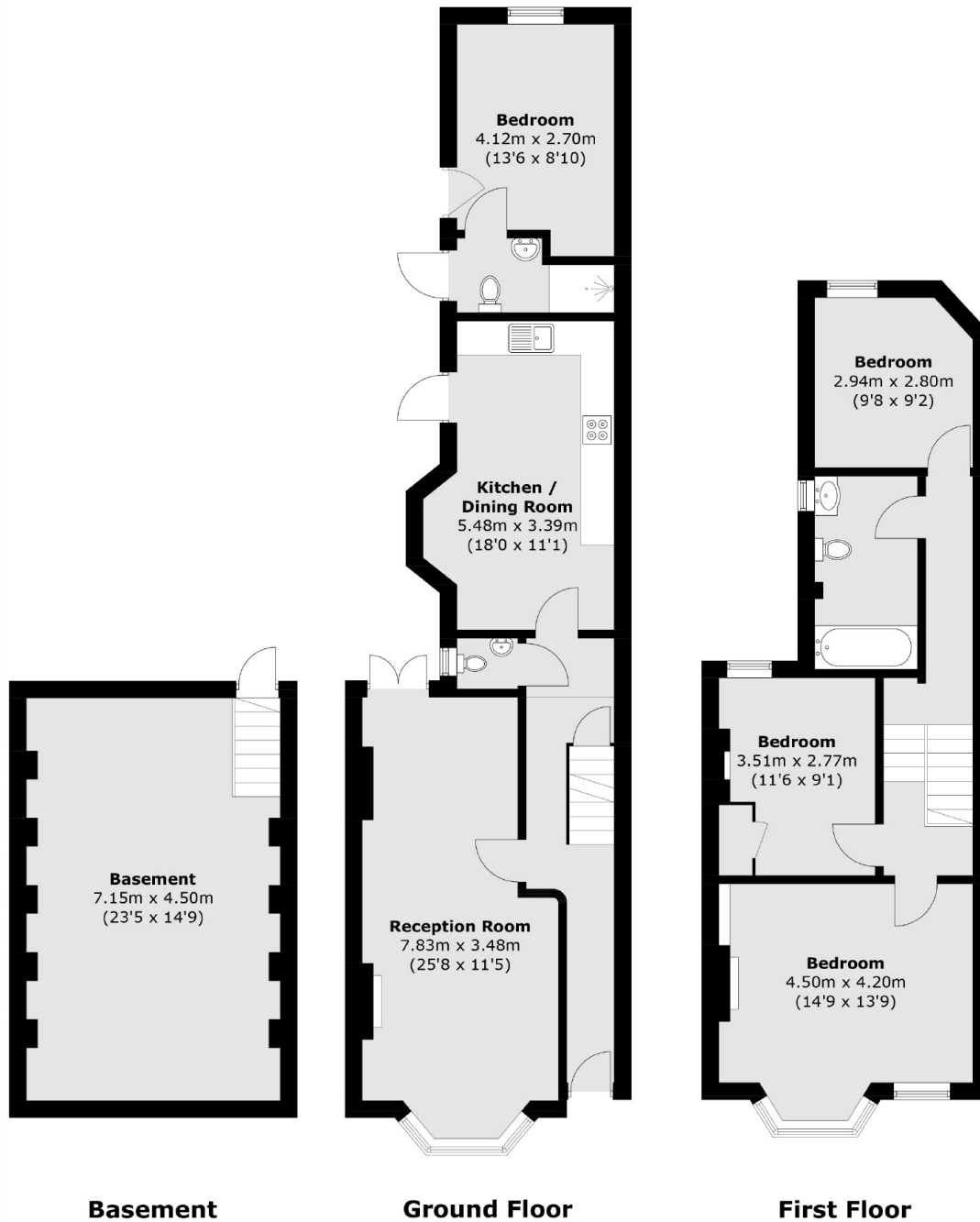

Total area (approx.): 152.1 sq. m (1,637.2 sq. ft)  
(Including Basement)