



Lower Clapton Road, E5

£325,000

A one double bedroom period conversion that has been renovated throughout by the current owner. The property has an open plan kitchen/living room, double aspect, bespoke storage & fixtures, modern bathroom and a long lease.

The green spaces of Clapton Square, Hackney Downs Park and Millfields Park are all within walking distance. Hackney Central & Hackney Downs Overground Stations are under half a mile away offering easy access to the rest of the City. Chatsworth Road and Mare Street's many cafes, restaurants, shops and market are nearby.

Features

- Offers Over
- One Double Bedroom
- Period Conversion
- Open Plan
- Long Lease
- Top Floor
- Clapton Square
- Recently Renovated

Lower Clapton Road, London, E5

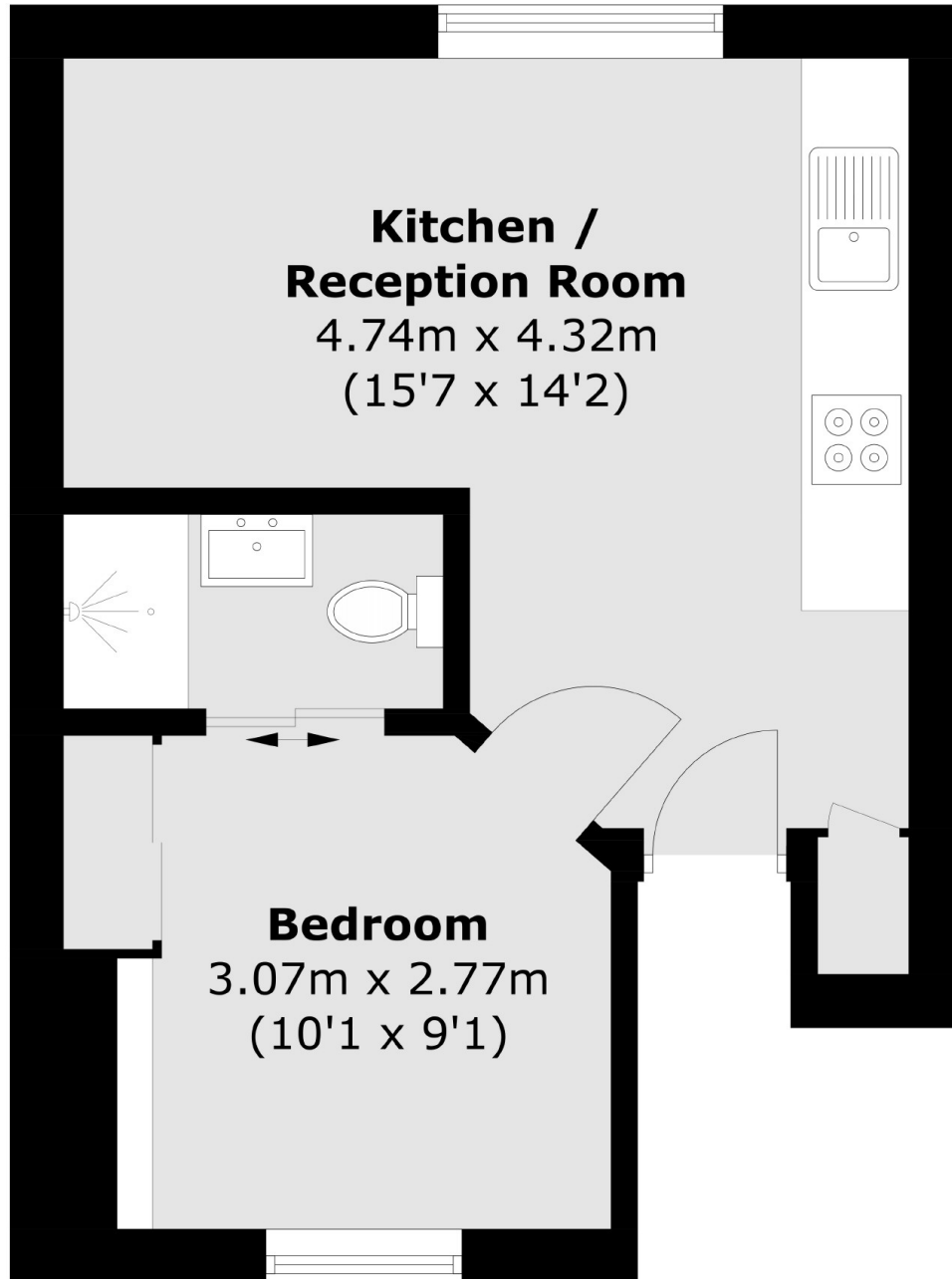

Total area (approx.): 27.9 sq. m (300.3 sq. ft)