



**Fassett Square, E8**

**£1,200,000**

**Dexters**





## Fassett Square, E8

An architecturally designed Victorian end of terrace on the famous East London Square. This two double bedroom home, over three storeys, has been renovated throughout to a high standard with bespoke cabinetry, walk in wardrobe, open plan kitchen/living room, engineered wooden flooring and loft extension. It is being sold with no onward chain.

This Hackney home is perfect for those seeking a stylish & contemporary property in a convenient and peaceful location. On the ground floor the double reception room has been opened up creating a spacious kitchen and living space with high ceilings, bay window and french doors leading to the cobbled patio garden. Upstairs is the principal double bedroom with walk in wardrobe and bathroom with stone and chrome finishes. In the loft is another double bedroom with wooden panelled ceiling and wall of sash windows. The bedrooms have beautiful views overlooking the gardens. You will have access to the private garden square for residents' only. This space can also be hired for private events.

Fassett Square is a quiet residential street running directly between Dalston and London Fields. The park and lido are within walking distance as well as popular Ridley Road & Broadway Markets. Hackney Downs, Hackney Central are less than half a mile away offering easy access into the City and the rest of London.

### Features

- Two Double Bedrooms
- Victorian End of Terrace
- Architecturally Designed
- Access to Garden Square
- No Onward Chain
- Private Garden













# Fassett Square, London, E8

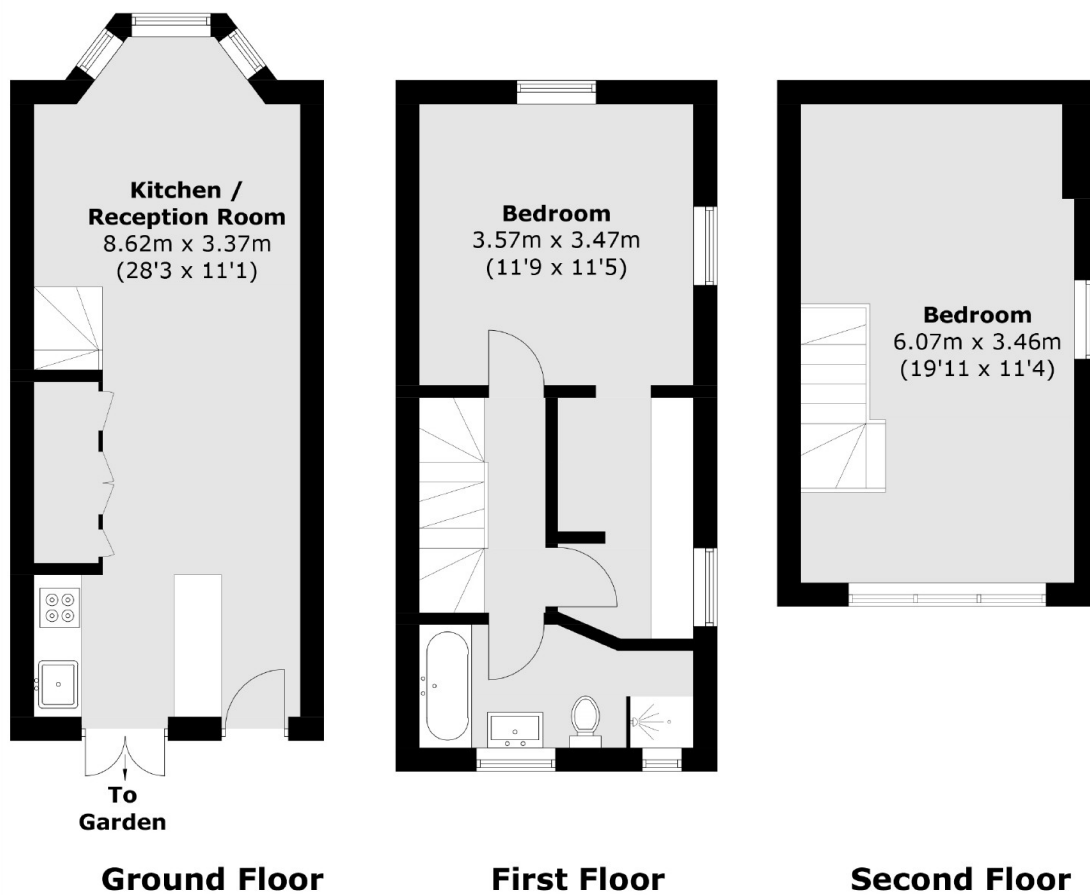

Total area (approx.): 77.3 sq. m (832.0 sq. ft)