



Argyle Road, IG1

£345 Per week

A beautifully presented one bedroom apartment on Argyle Road. This property comes with a large open plan reception, walk-in wardrobe, private garden at the rear and off street parking space.

Ideally positioned for the IG1 location, moments restaurants and Ilford railway Station

Features

- One Double Bedroom
- Wooden Flooring
- Open Plan
- Walk-in Wardrobe
- Private Garden
- Parking

Argyle Road, Ilford, IG1

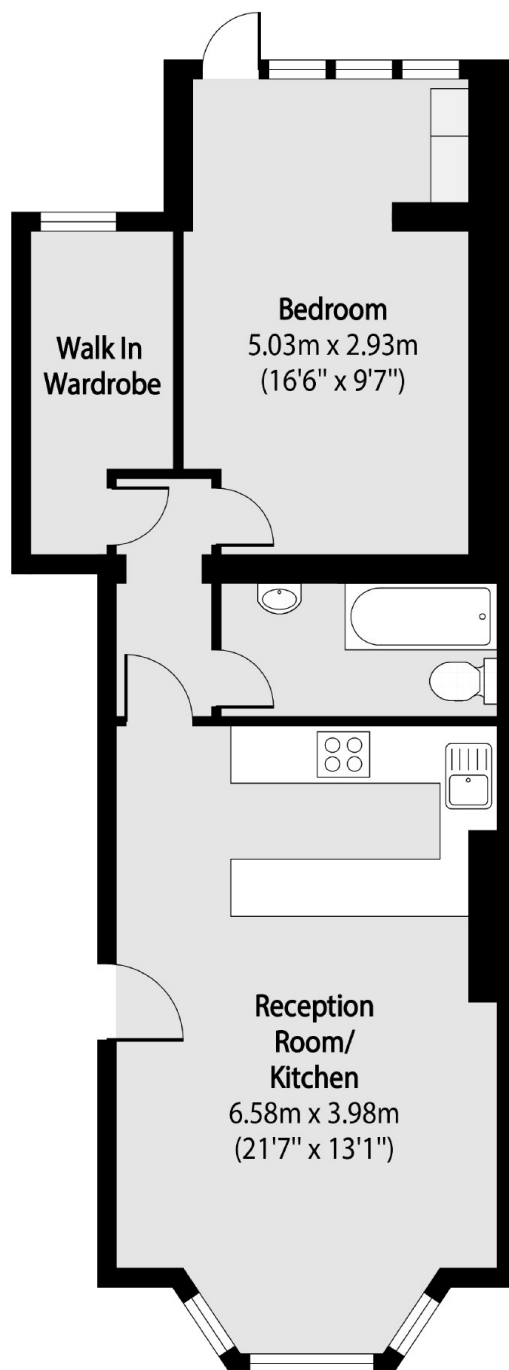

Total area (approx): 52.08 sq m (561 sq. ft)