



Warwick Grove, E5

£270,000

A one bedroom apartment with private balcony located within a purpose built block in Upper Clapton. The property benefits from having lift access, double aspect, a separate kitchen & W/C and being sold chain free.

The property is located in the middle of the popular green spaces of Springfield Park and Walthamstow Marshes. In addition to there being numerous bus links close by, Clapton Overground Station is within walking distance.

Features

- Offers Over
- One Double Bedroom
- Private Balcony
- Purpose Built Block
- Close to Springfield Park
- Lift Access
- Chain Free

Warwick Grove, London, E5

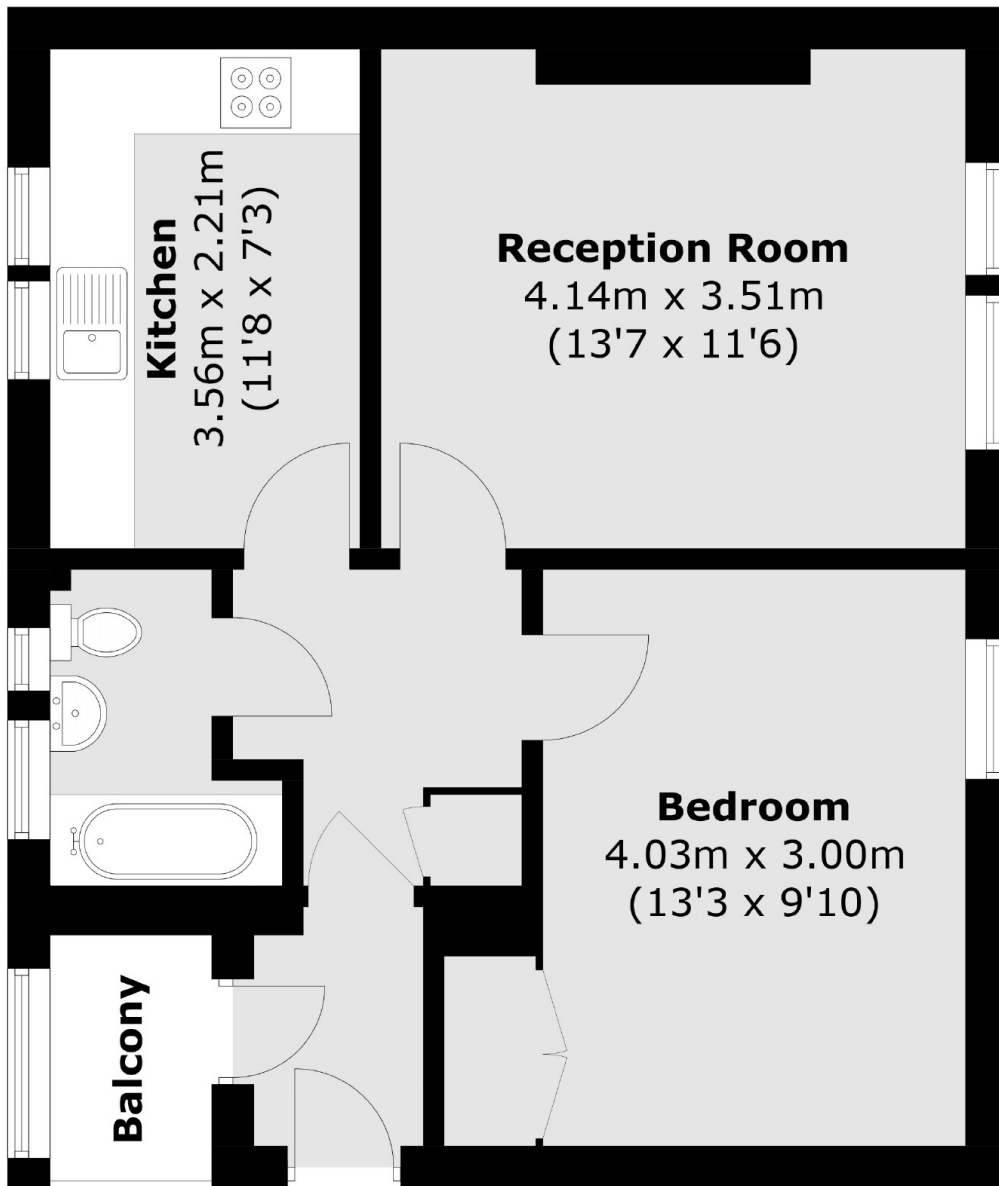

Total area (approx.): 48.2 sq. m (518.8 sq. ft)
Balcony: 2.0 sq. m (21.5 sq. ft)