



**Clifden Road, E5**

**£1,075,000**

**Dexters**



## Clifden Road, E5

A five double bedroom Victorian terraced house on the sought after Clifden Road. The property has been refurbished by its current owners with a loft extension, double reception room, kitchen/diner and large private garden.

With a smart white facade the house offers over 1480 sq ft of living space across three storeys. The home has high ceilings and double glazed windows throughout.

On the ground floor is a double reception room and galley kitchen with space to dine and double doors leading to the garden. There is a side return currently used as storage with separate W/C.

Upstairs, the first floor offers three double bedrooms with wooden flooring and a family bathroom.

The loft has two further double bedrooms with skylights and eaves storage.

Clifden Road is around the corner from the popular Chatsworth Road with its many cafes, restaurants, shops and Sunday Market. It is situated within the catchment of many outstanding schools making it perfect for a family.

Homerton Overground is half a mile away and under one mile from Hackney Central and Hackney Downs offering excellent transport links to the rest of the City.

### Features

Offers Over  
Victorian Terrace  
Five Bedrooms  
Garden  
Loft Extension  
Chatsworth Road







# Clifden Road, London, E5

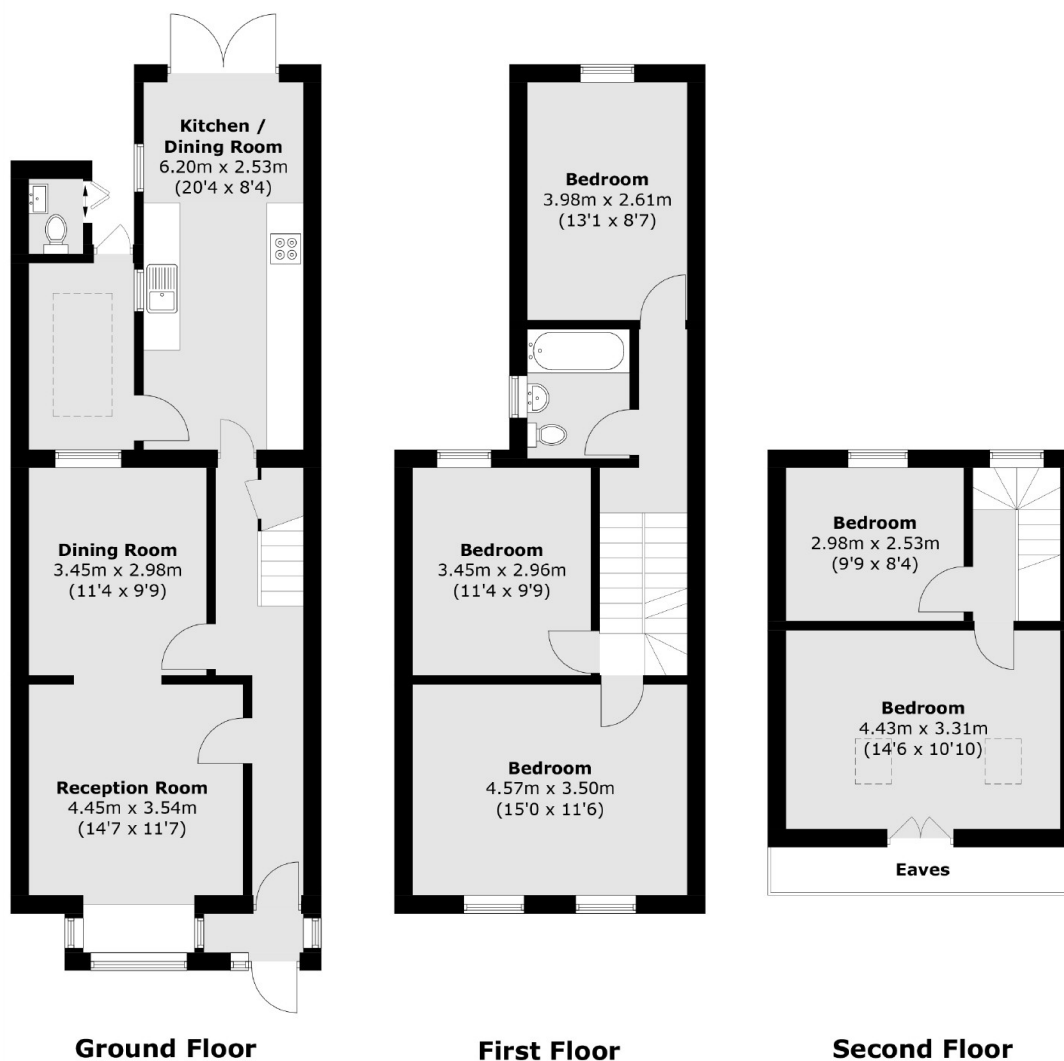

Total area (approx.): 137.7 sq. m (1,482.2 sq. ft)  
(Excluding Eaves)