



Lower Clapton Road, E5

£350,000

A one double bedroom period conversion that has been thoughtfully renovated throughout. The property has an open plan kitchen living area, sash windows, wooden flooring, modern bathroom and high ceilings. It is being sold chain free and furnishings are available to purchase separately.

The green spaces of Clapton Square, Hackney Downs Park and Millfields Park are all within walking distance. Hackney Central & Hackney Downs Overground Stations are under half a mile away offering easy access to the rest of the City. Chatsworth Road and Mare Street's many cafes, restaurants, shops and market are nearby.

Features

- Offers Over
- One Double Bedroom
- Period Conversion
- Sash Windows
- Open Plan
- Long Lease
- Chain Free

Lower Clapton Road, London, E5

First Floor

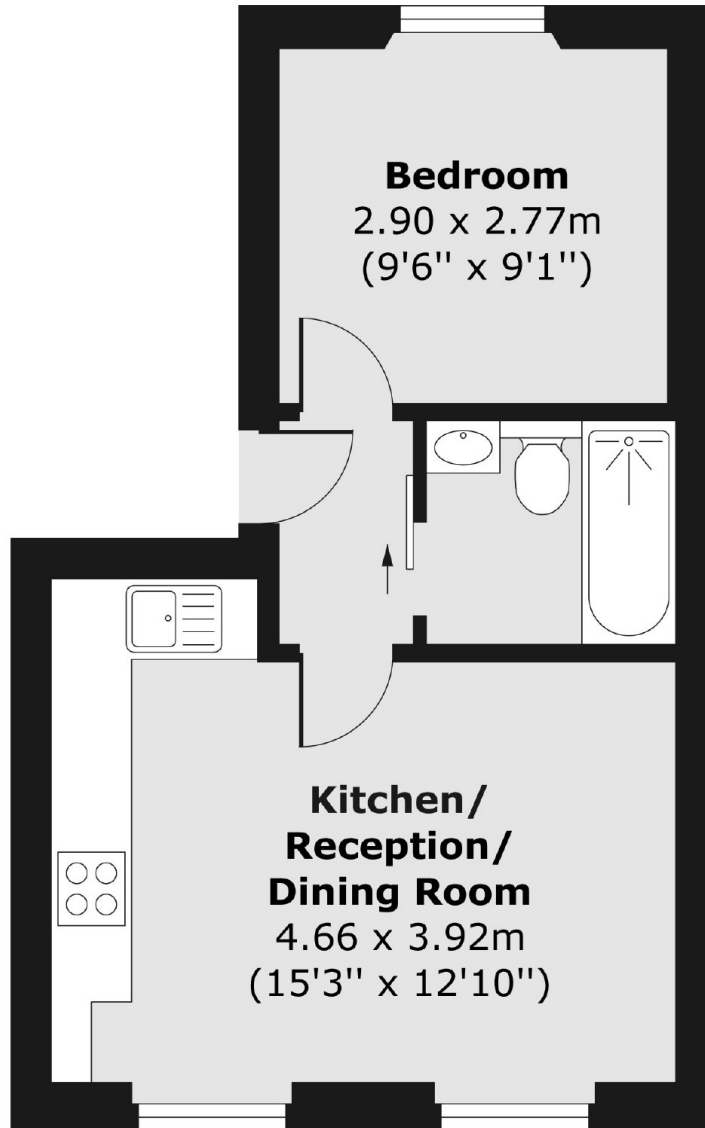

Total area (approx.) 29.61 sq. m (319 sq. ft)