



Clapton Common, E5

£599,000

A two double bedroom, two bathroom modern apartment overlooking Clapton Common. The property benefits from open plan kitchen living space, balcony, en-suite bathroom, lift access, secure entry and a long lease.

Cedarwood Court is only half a mile from Stamford Hill Overground and there are many bus routes nearby offering easy access to the City. The location is spoilt by having Hackney Marshes, Springfield Park and the River Lea in close proximity.

Features

- Two Double Bedrooms
- Two Bathrooms
- Open Plan
- Modern
- Lift Access
- Balcony overlooking Clapton Common

Clapton Common, London, E5

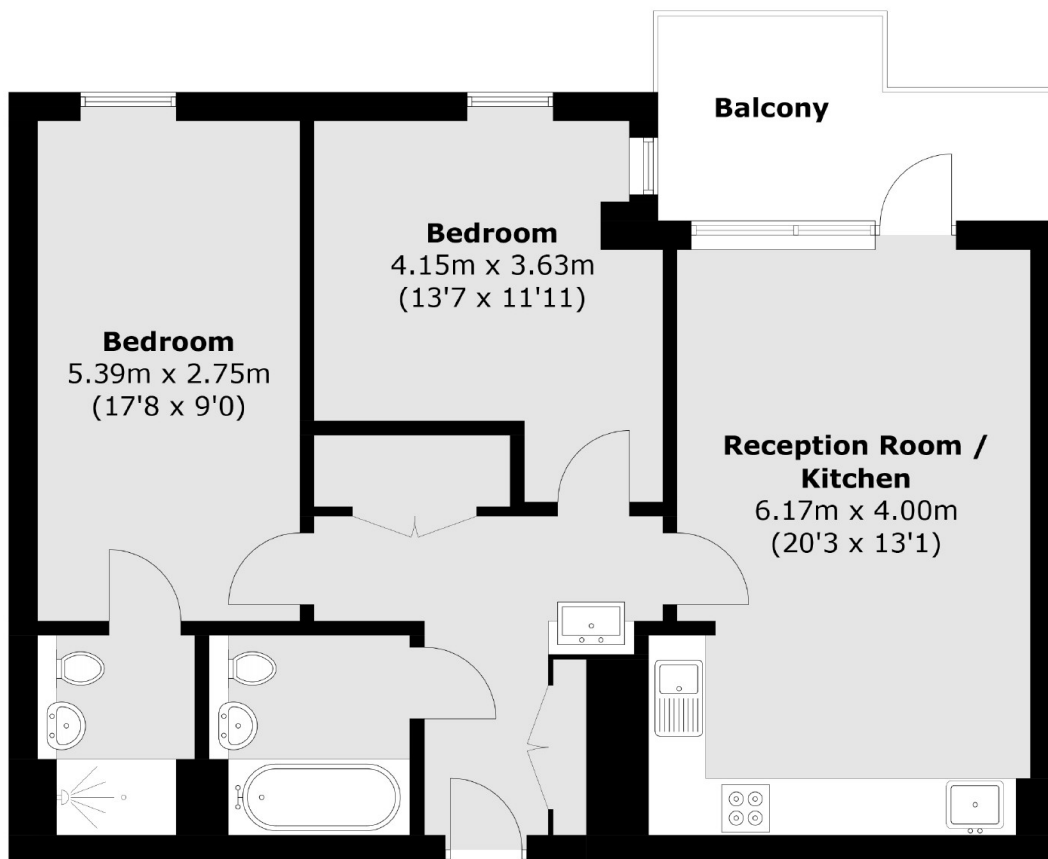

Total area (approx.): 72.4 sq. m (779.3 sq. ft)
Balcony: 7.5 sq. m (80.7 sq. ft)