

## Graham Road, E8

£600,000

A two double bedroom apartment within a period townhouse. The property has large sash windows that provide natural light throughout. Offered with no onward chain.

Graham Road runs between Dalston and Mare Street, with endless shops and amenities to choose from including Broadway Market. Hackney Central overground on the same road.

### Features

Offers In Excess Of  
Share of Freehold  
Two Double Bedrooms  
Sash Windows  
Hackney Central Overground  
London Fields

# Graham Road, London, E8

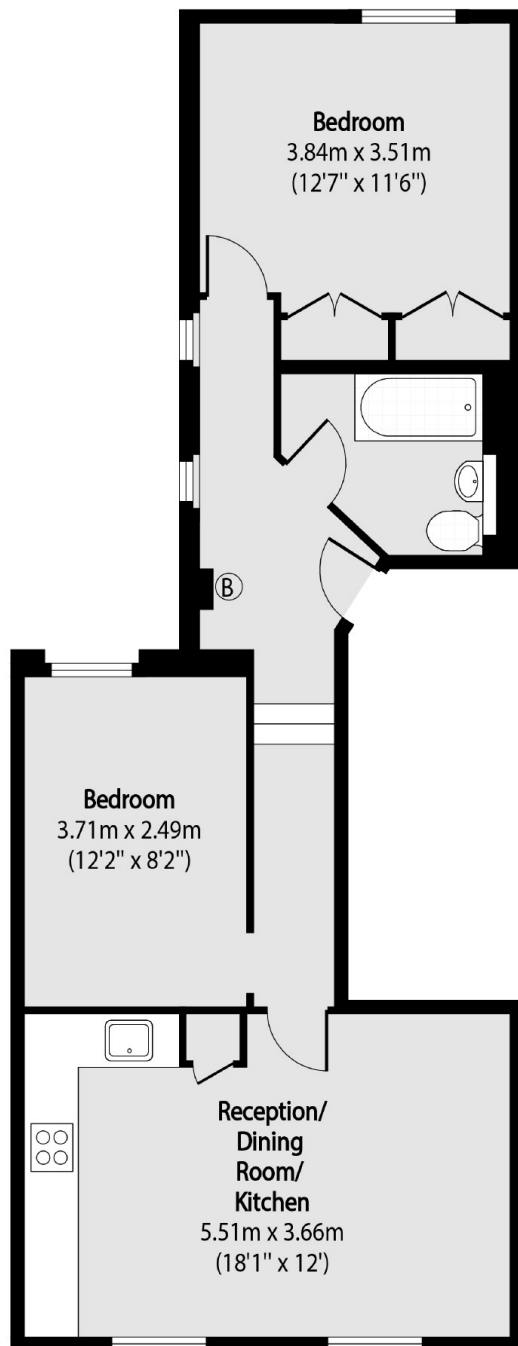

Total area (approx): 56.49 sq m (608 sq. ft)