



Sigdon Road, E8

£450,000

A unique one double bedroom warehouse conversion in the heart of Hackney. Originally built in the early 1900's the property has been modernised and renovated throughout and has high ceilings, sash windows, and secure entry within a gated development. It is being sold chain free and has parking available.

Albion Works Studios is located on Sigdon Road and is 400 ft from Hackney Downs and half a mile from Hackney Central Overground Stations. The many shops, cafes and restaurants of Hackney Central are on your doorstep.

Features

- One Double Bedroom
- Warehouse Conversion
- Recently Refurbished
- Gated Development
- Parking Available
- Chain Free
- Long Lease

Sigdon Road, London, E8

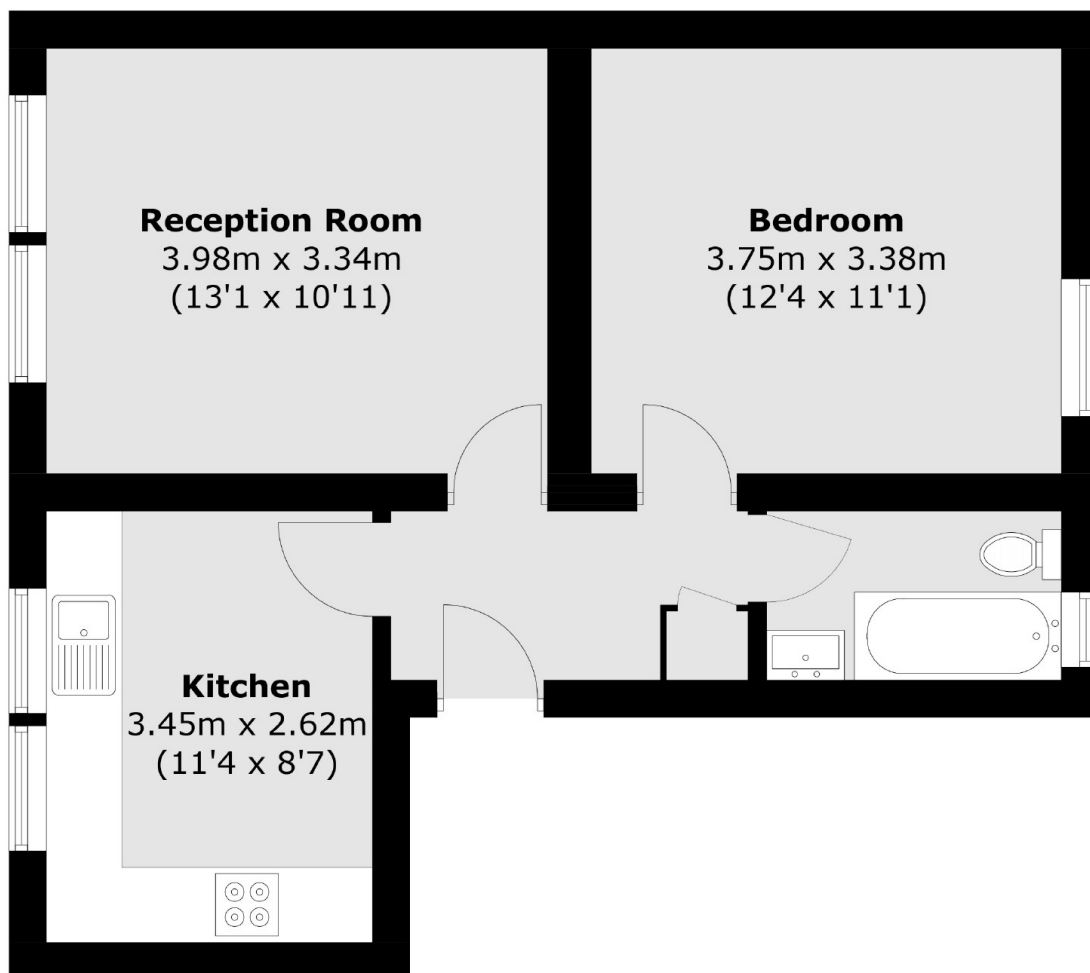

Total area (approx.): 46.5 sq. m (500.5 sq. ft)