



## Rectory Road, N16

£370,000

A two double bedroom apartment located on the ground floor within a low rise purpose built block next to Hackney Downs. The property measures over 640 sq ft and has a separate kitchen & W/C.

The Beckers is located within walking distance of Church Street and its many bars, shops and restaurants as well as Stoke Newington Road and Kingsland Road. Rectory Road Overground is under a quarter of a mile walk giving you excellent transport links into the City. Hackney Downs Park is a very short walk away.

### Features

- Two Double Bedrooms
- Separate Kitchen
- Perfect for Investors
- Small Block
- Over 640 sq ft
- Hackney Downs

# Rectory Road, London, N16

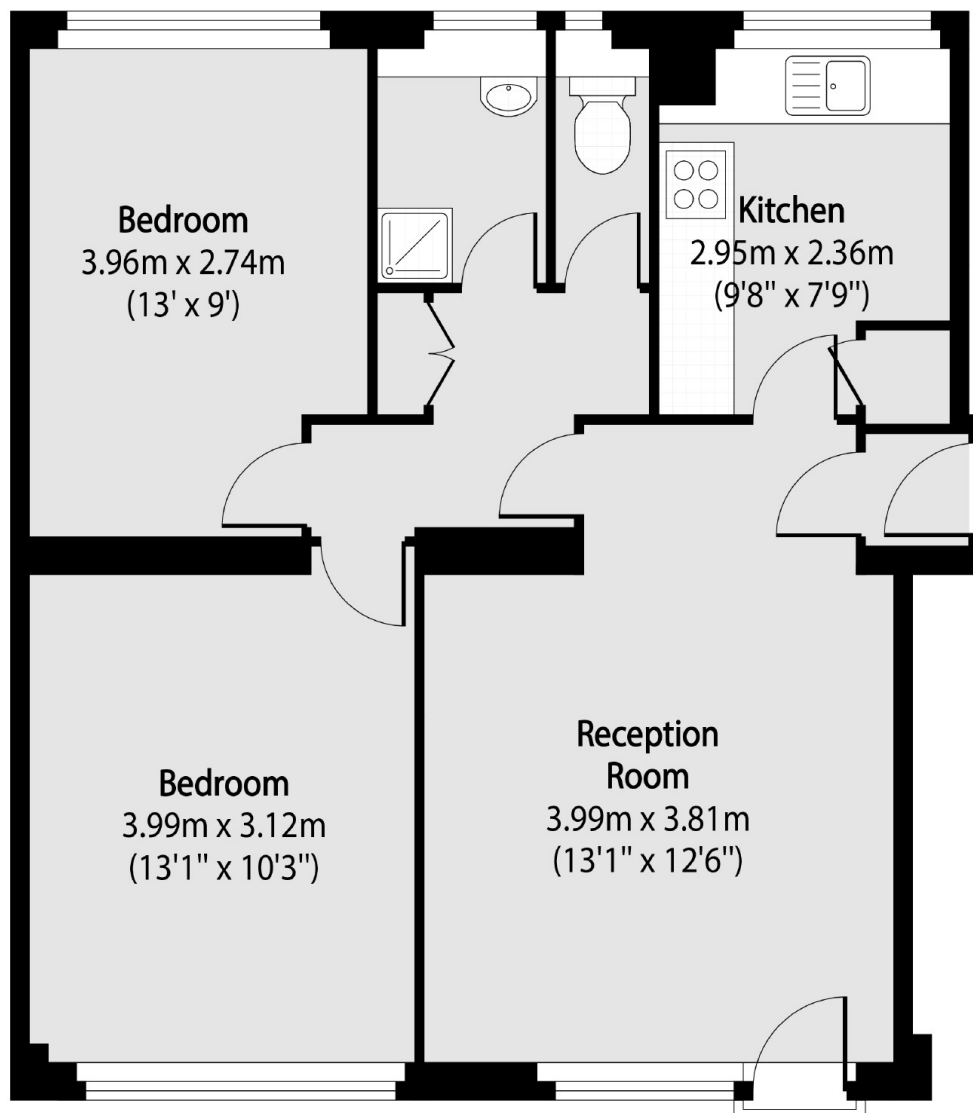

Total area (approx): 59.83 sq m (644 sq. ft)