



Springfield, E5

£325,000

This bright one double bedroom apartment, measuring over 530 sq ft, is in excellent condition and situated within a purpose-built block next to Springfield Park. The property has a separate kitchen with space to dine, modern bathroom, bay window and stylish hard flooring. The building has secure entry and communal gardens.

Lea View House is ideally located next to the green spaces of Springfield Park, Walthamstow Wetlands as well as the Stanstead Mill Stream. Clapton Overground Station is half a mile away and frequent bus routes are available at the end of the road providing great links to the rest of the City.

Features

Offers Over
One Double Bedroom
Double Aspect
Excellent Condition
Springfield Park
Walthamstow Wetlands

Springfield, London, E5

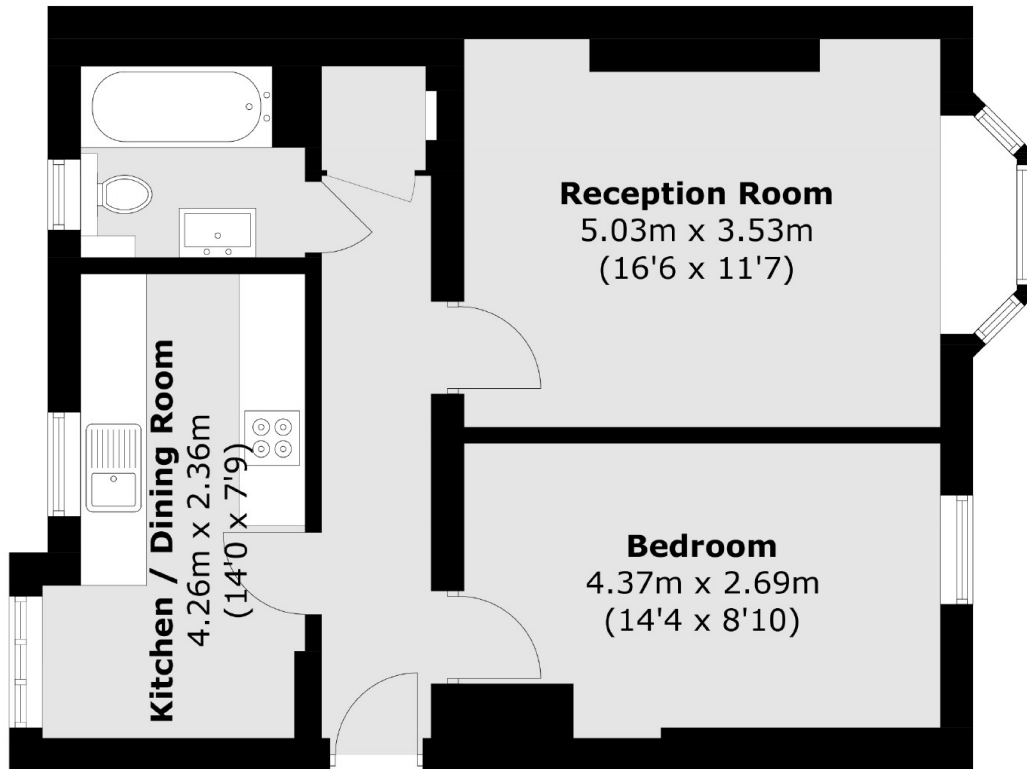

Third Floor

Total area (approx.): 49.7 sq. m (535.0 sq. ft)