



Sutton Square, E9

£450,000

A one double bedroom located in the award winning Sutton Square development. The apartment benefits from being on the top floor, separate kitchen, wooden floors, communal gardens and a long lease.

Sutton Square is located next to Hackney Church and its gardens. It is under half a mile from Hackney Central and Hackney Downs Overground Stations. There are many restaurant's, cafes and shops within walking distance.

Features

- One Double Bedroom
- Communal Gardens
- Secure Entry
- Top Floor
- Chain Free

Sutton Square, London, E9

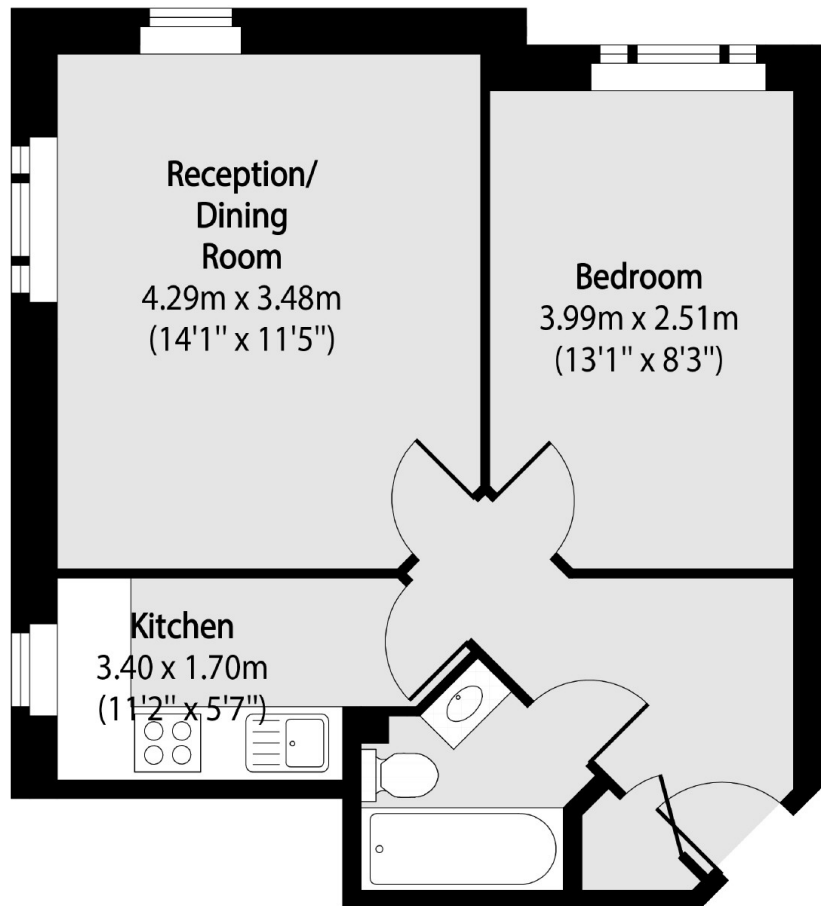

Total area (approx): 38.83 sq m (418 sq. ft)