



Stamford Hill, N16

£375,000

A two bedroom split level apartment on the third and fourth floor. The property offers two double bedrooms, a bathroom, a reception room and a separate kitchen. The property is within close proximity to Stoke Newington Church Street.

Stoke Newington Station (Overground) is a short walk away providing access to Liverpool Street and Seven Sisters Underground Station (Victoria Line). The property is situated in close proximity to the popular Stoke Newington Church Street with its boutique shops and restaurants. There are excellent transport links to The City and West End with numerous good bus routes.

Features

- Purpose Built
- Two Double Bedrooms
- Split Level
- Great Location
- Good Transport Links

Stamford Hill, London, N16

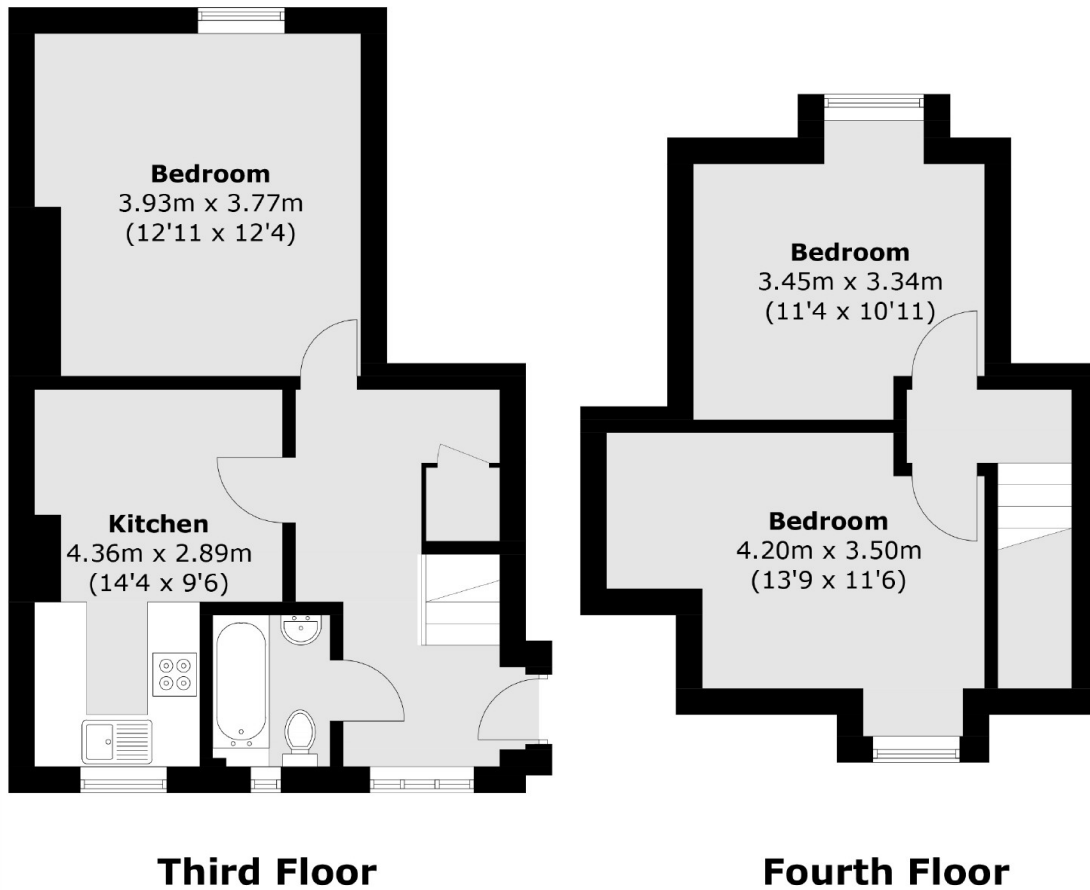

Total area (approx.): 65.6 sq. m (706.1 sq. ft)