

SCARGILL
MANN & Co

EST. 1995

TO LET

15 The Hallsteads, Kniveton, Ashbourne, Derbyshire, DE6 1JT

£1,000 Per Calendar Month



- Ideal family home
- Entrance hallway with utility area
- Guest cloakroom and kitchen
- Three further bedrooms and family bathroom
- Stunning open countryside views
- Oil fired central heating and sealed upvc double glazing
- Open plan L-shape living / dining room
- Master bedroom with en-suite enjoying stunning elevated views of open countryside
- Wrap around south facing garden

THE PROPERTY

An ideal family home. Extended four bedroomed end town house occupying a popular location within the village of Kniveton, enjoying stunning open countryside views with southerly aspect. Oil fired central heating and sealed unit upvc double glazing. Internally briefly comprises of entrance hallway, utility area, guest cloakroom, open plan dining / sitting room and kitchen. To the first floor is a master bedroom with en-suite, three further bedrooms and a family bathroom. No smokers. Available May 2024.

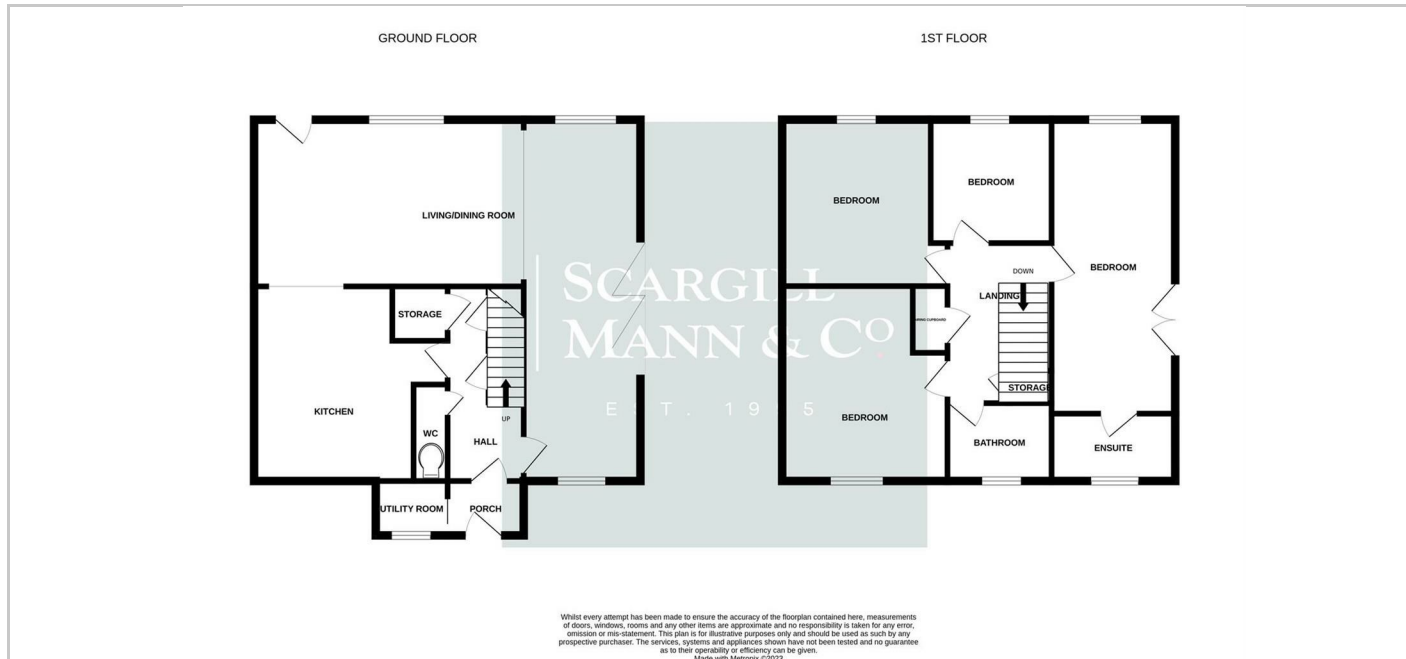

SITUATION

Directions

17 Mallard Way, Derby, Derbyshire, DE24 8GX
Tel: 01332 206620 Email: lettings@scargillmann.co.uk