

Lizmans Terrace, W8

Guide Price £1,150,000

🛏 2 🍷 2 🛋 1



- Guide Price: £1,150,000 to £1,250,000
- Private entrance and private garden
- Fantastic Kensington location
- Large principle bedroom with en-suite
- Neutral finish with wooden floors throughout
- Bright and airy
- Underfloor heating throughout
-
-

Lizmans Terrace
 Approx. Gross Internal Area 953 Sq Ft - 88.54 Sq M

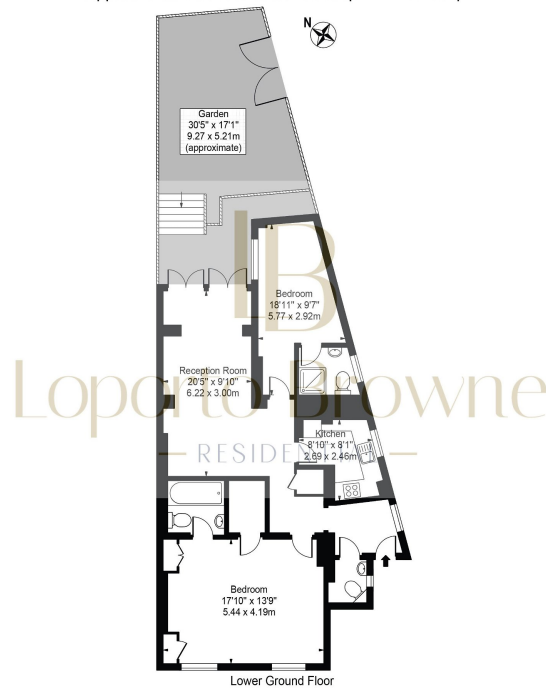

Lower Ground Floor
For Illustration Purposes Only - Not To Scale

This floor plan should be used as a general outline for guidance only and does not constitute in whole or in part an offer or contract.
 Any intending purchaser or lessee should satisfy themselves by inspection, searches, enquiries and full survey as to the correctness of each statement.
 Any areas, measurements or distances quoted are approximate and should not be used to value a property or be the basis of any sale or let.

Guide Price: £1,150,000 to £1,250,000

Set back from the road, this delightful two bedroom garden flat benefits from side access from Stratford Road and its own private entrance.

This spacious and elegant two-bedroom maisonette is situated in the highly sought-after area south of Kensington High Street. This charming property features its own private street entrance, providing a sense of exclusivity and convenience. The flat has been refurbished to a high standard and benefits from wood flooring throughout.

Oli & Liana are delighted to be instructed to help sell this exceptional opportunity to acquire a beautifully presented garden flat in one of London's most desirable neighbourhoods. Early viewing is highly recommended.