



LB

Loporto Browne

— RESIDENTIAL —

Flat 16, Hillcrest Court, Shoot Up Hill

£3,000PCM (Deposit: £3,000)

🛏️ 3 🚿 2 🛋️ 1



- Beautifully presented art-deco mansion block
- Dual aspect bathed with light and far reaching views
- Finished to a high standard with plenty of storage throughout
- Excellent transport links
- 3 bed, 2 bathroom set on the third floor with lift
- Wooden floors and carpeted bedrooms
- Principle bedroom with built in wardrobes
- Close to amenities
- 140 year lease and 901 square foot

Tax Band: D Furnished: Not specified

Guide Price: £575,000 to £600,000

Loporto Browne presents a three-bedroom two-bathroom lateral flat with triple aspect. The property has two double bedrooms, one single bedroom and two beautifully designed bathrooms, there is a separate ergonomic kitchen. This fantastic flat is ready to move into.

Hillcrest Court is an Art-Deco mansion block with original features from the art deco era. Due to its positioning and aspect, it is bathed in natural light and has great far-reaching views. The building is secure and well maintained and is ideal for all demographics from young families to retired couples, sharers or any buy to let investors as it can also potentially reach a fantastic yield. The flat is situated on the third floor and at the end of the corridor. Parks are within easy reach as it is close to Hampstead Heath and Ladbroke Park so you are spoilt for choice.

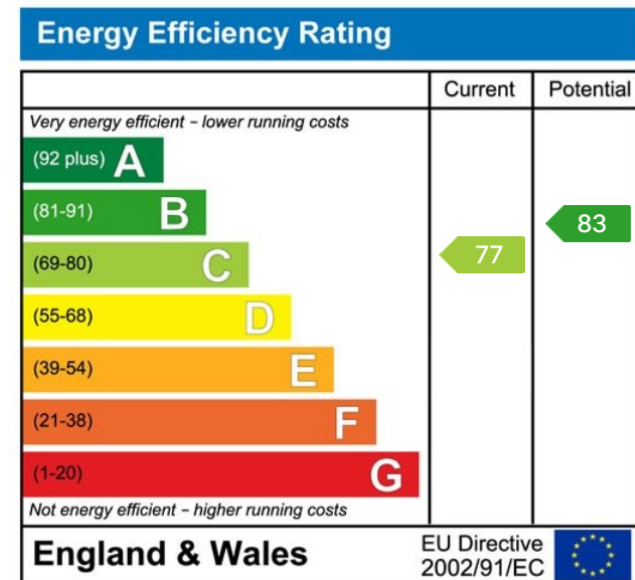
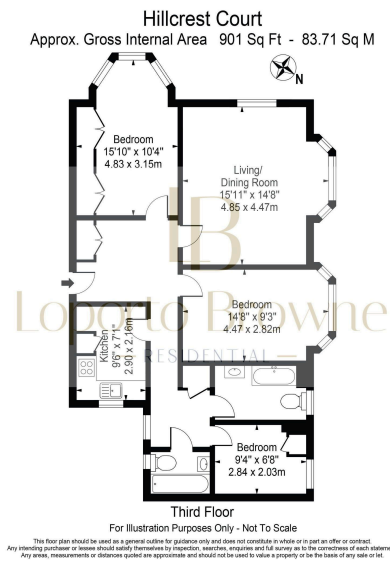

LB Residential
Grand Union Studios
332 Ladbroke Grove
W10 5AD

Email: hello@lbresidential.co.uk
Web: www.lbresidential.co.uk
Tel: 0203 062 6262