



LB

Loporto Browne

— RESIDENTIAL —

# Gloucester Place, NW1

Guide Price £650,000

🛏️ 2 🪑 1 🚗 1



- A charming 2-bedroom top-floor period conversion spanning over two levels
- Accessed via a lift
- Kitchen and space for dining
- Enjoys excellent transport links
- Service charge includes heating and hot water
- Perfect blend of historic character and modern convenience
- Boasts a spacious open-plan reception room
- Located in this desirable part of NW1
- Regent's Park is just a short stroll away
- Liana & Oli are delighted to be instructed as sole agents on this wonderful home



**Guide Price £650,000 to £700,000**

A rare opportunity to own a bit of Georgian history in one of London's most iconic areas. This charming 2-bedroom, bright, top-floor period conversion, situated in the highly sought-after Gloucester Place, offering the perfect blend of historic character and modern convenience. Spanning two levels, this beautifully presented property is accessed via a lift and boasts a spacious open-plan reception room, complete with a kitchen and space for dining. It also enjoys a communal roof terrace conveniently located on the same floor just opposite the apartment.

This home features two generously sized double bedrooms, both filled with natural sunlight, and a main bathroom. The split-level layout provides a wonderful sense of space and separation between the levels.

Liana & Oli are the wonderful home

Gloucester Place  
Approx. Gross Internal Area 567 Sq Ft - 52.64 Sq M

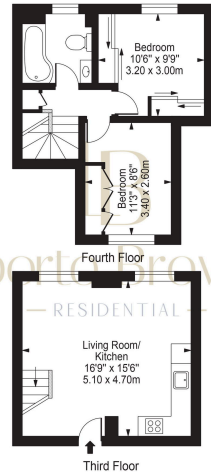

For Illustration Purposes Only - Not To Scale

This floor plan should be used as a general guide for guidance only and does not constitute an offer or contract. Any intending purchaser or lessee should satisfy themselves by inspection, surveys, enquiries and full survey as to the correctness of each statement. Any errors, measurements or dimensions quoted are approximate and should not be used to value a property or be the basis of any sale or let.

