





# Whittle Close, Southall UB1

£304,995

🛏 2 🚿 1 🛋 1





## Spacious 2-Bedroom Split-Level First Floor Flat

This beautifully presented two-bedroom split-level first-floor flat offers generous living space and a modern finish throughout. Recently newly decorated, the property boasts a bright and airy feel, perfect for comfortable living.

The flat features:

- Two well-proportioned bedrooms
- A modern kitchen with stylish fittings
- Spacious living area
- Family bathroom plus a separate downstairs WC
- Large storage shed, ideal for extra space
- Situated in a convenient location, this home is perfect for first-time buyers, professionals, or small families looking for a stylish and well-maintained property.

Don't miss out—book a viewing today!



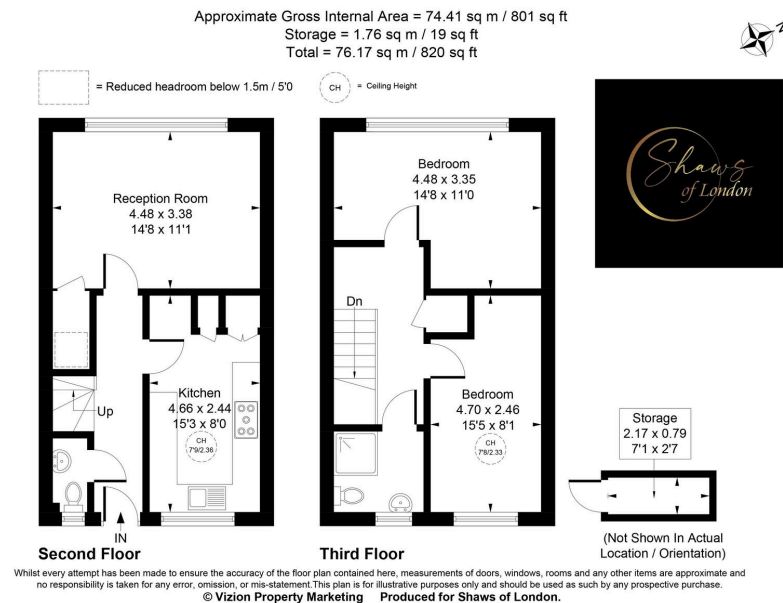

- Two well-proportioned bedrooms
- A modern kitchen with stylish fittings
- Family bathroom plus a separate downstairs WC
- Ideal for first-time buyers, professionals or small families
- Spacious living area
- Large storage shed

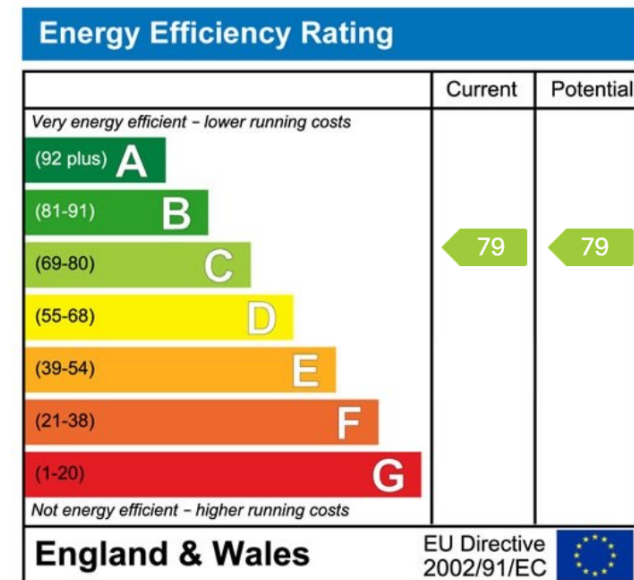

910 Uxbridge Road, Hayes  
 Middlesex UB4 0RW

info@shawsoflondon.co.uk  
 www.shawsoflondon.co.uk

020 8561 6888

@shawsoflondon

“Shaws of London” is the trading name of Shaw & Co Estates (UK) Ltd