



Carnarvon Drive, Hayes, UB3 1PT

Guide Price £799,950

🛏 5 🚗 2 🚗 2



STUNNING FAMILY HOME!! Shaws of London bring to market this fantastic Four/Five bedroom semi-detached family home. Upon entering to your right hand side there is a large through lounge, to the left is a ground floor study/bedroom, further back is a stunning bathroom suite, and a rear large open plan kitchen/diner/reception area. Upstairs are four very spacious bedrooms & a further family shower suite. Located close to Hayes & Harlington Station, Hayes Town & Heathrow Airport. Comes with parking for 3-4 cars, a large private rear garden over 80 foot long, rear garage for storage & Potential for loft extension, double storey side extension STPP. Viewings are highly recommended and not to be missed. Call our sales team to view!

910 Uxbridge Road, Hayes
Middlesex UB4 0RW

info@shawsoflondon.co.uk
www.shawsoflondon.co.uk

020 8561 6888

@shawsoflondon

- Beautiful Family Home
- Stunning Condition Throughout & Newly Renovated
- Large Rear Garden Over 80 Foot Long
- Driveway For 3-4 Cars
- Walking Distance To Hayes Town & Hayes & Harlington Station
- Four/Five Bedroom Semi-Detached
- Ideal First Time Purchase
- Rear Garage For Storage/Parking
- Stone Throw Away From Pinkwell Primary School
- One Bus To Heathrow Airport

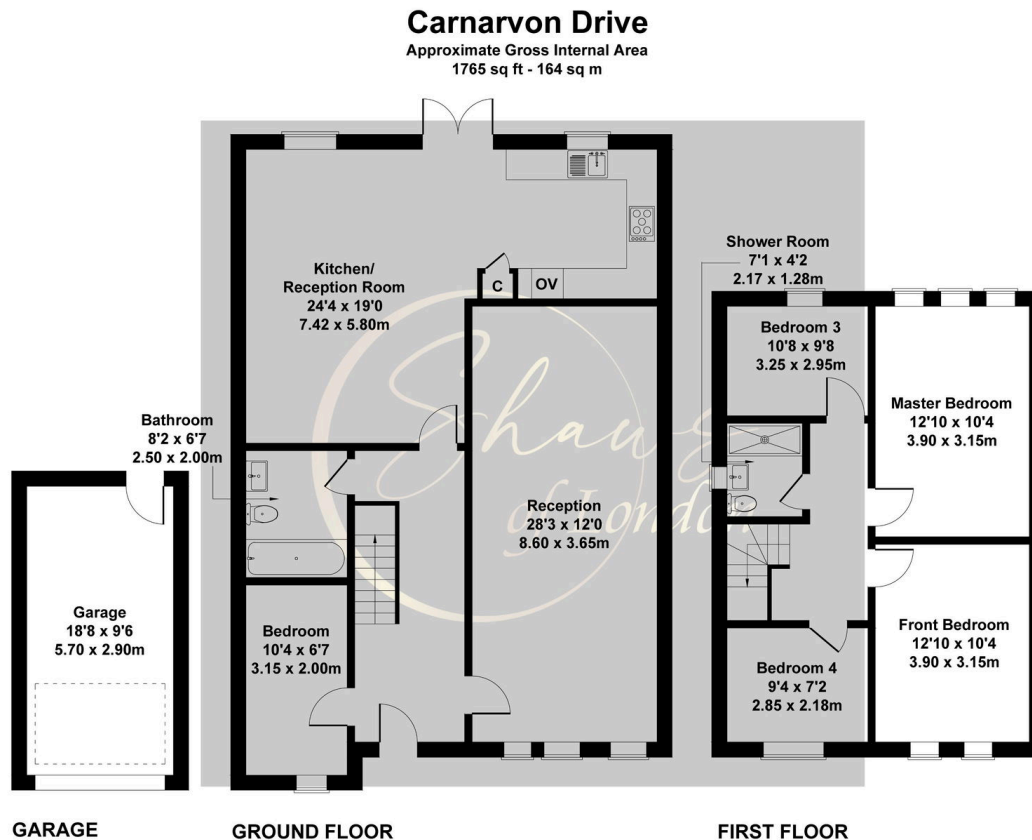

Not to Scale. Produced by The Plan Portal 2024
For Illustrative Purposes Only.

910 Uxbridge Road, Hayes
Middlesex UB4 0RW

info@shawsoflondon.co.uk
www.shawsoflondon.co.uk

020 8561 6888

 @shawsoflondon