



Hemmen Lane, Hayes

Offers In Region Of £549,950

 3  2  1



EXCELLENT LOCATION!! Shaws of London present a wonderfully renovated three/four bedroom terraced family home situated minutes from Hayes Town. Property has gone under a substantial upgrade with newly fitted windows, newly laid driveway, new paint throughout, fitted wardrobes and a new bathroom fitted. Comprising three spacious bedrooms, large sitting room leading into an extended family kitchen & two bathrooms suites. Comes with a large rear garden over 80 foot long, rear annexe, driveway for two/three cars & rear access. Walking distance to Dr Triplett's Ce Primary School, Hayes Town, Hayes & Harlington Station and all local shops & amenities. Call our sales team to view!

910 Uxbridge Road, Hayes
Middlesex UB4 0RW

info@shawsoflondon.co.uk
www.shawsoflondon.co.uk

020 8561 6888

 @shawsoflondon

- Excellent Location
- Stunning Condition
- Close To Dr Triplett's Ce Primary School
- Rear Annexe
- Potential For Loft Extension STPP
- Three/Four bedroom Terraced House
- Newly Renovated Throughout
- Large Garden 80 Foot Long
- Extended Family Home

Hemmen Lane

Approximate Gross Internal Area
1528 sq ft - 142 sq m

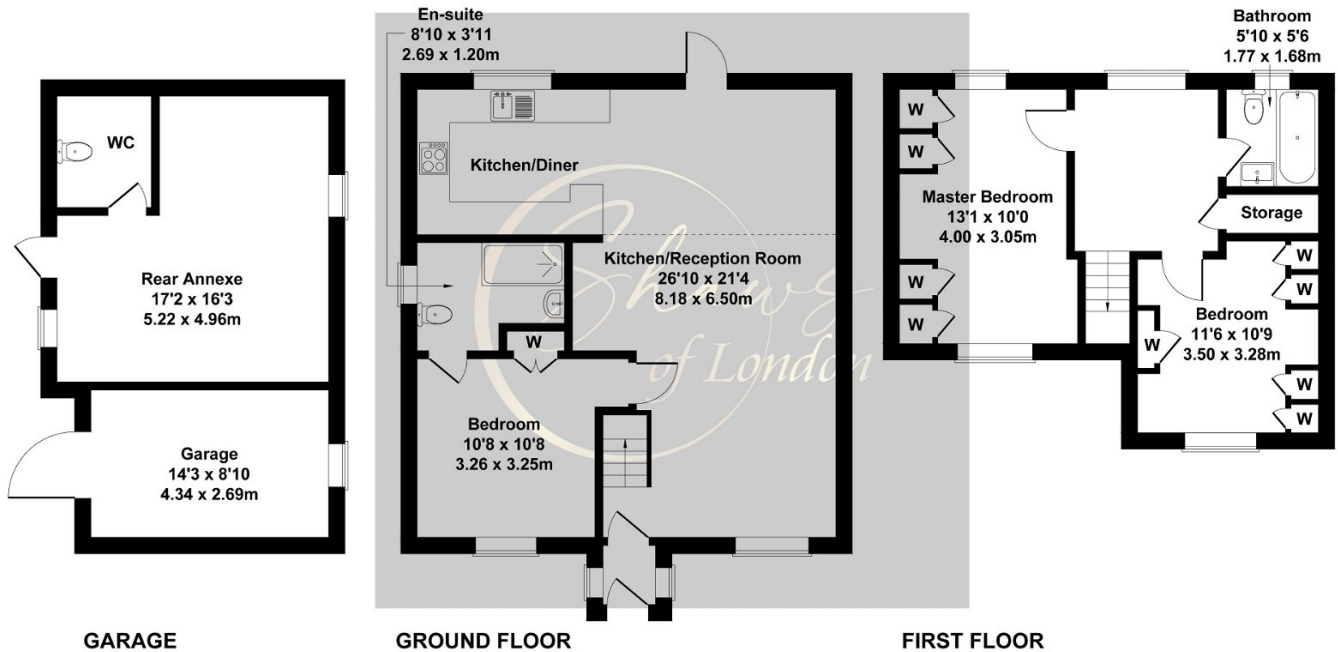

Not to Scale. Produced by The Plan Portal 2024
For Illustrative Purposes Only.