

Park Lane, Hayes, UB4 8AB

Guide Price £614,950

3 1 2



- Stunning Three Bedroom Semi-Detached Family Home
- Parking For 2-3 Cars
- Private Rear Garden Over 150 Foot Long (Large Plot)
- Large Rear Garage
- Close To All Local Shops/Amenities
- Premier Road In North Hayes
- Recently Renovated
- Extra Storage Room In Loft
- Open Day Saturday 22nd June 12.00pm - 1.30pm (via appointment only)
- Walking Distance To Hayes Park Schools & Hewens College

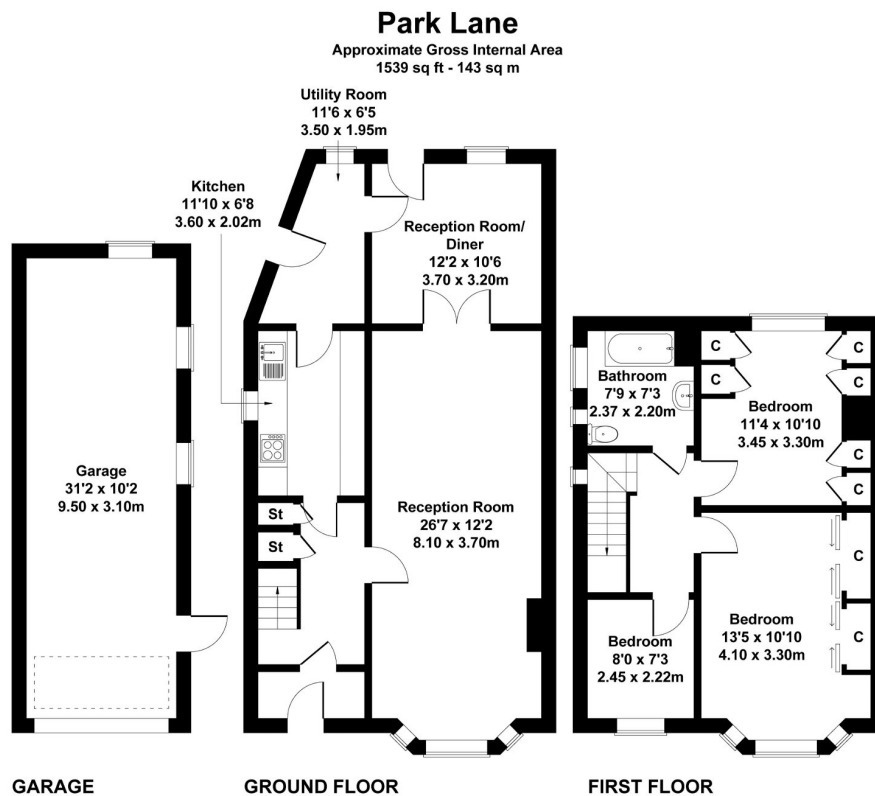

Not to Scale. Produced by The Plan Portal 2024
For Illustrative Purposes Only.



SIMPLY STUNNING!! Shaw & Co Estates Hayes bring to market a fabulous extended family home located on a Premier road in North Hayes. This property has been recently renovated and comes with a stunning through lounge/diner, addition reception/diner, sizeable kitchen, utility room, three spacious bedrooms and a family shower suite. Benefiting from double glazed windows, gas central heating, off street parking for two/three cars, private rear garden over 150 Foot long & a large rear garage over 9 meters long. Located a short walk to Hayes Park School, Hewens

College and excellent bus links to Uxbridge Town Centre & Heathrow Airport. This property is not to be missed. Open day 22nd June 12pm - 1.30pm (via appointment only). Call our sales team now to view.