



2 Floors

2/3
Bedrooms

1 En suite

DOYLE TWO / THREE BEDROOM HOME

A two / three bedroom semi-detached home with a perfectly proportioned lounge and a stunning open plan kitchen / dining room with a separate utility room, cloakroom and French doors opening onto the rear garden. Upstairs the spacious master suite is complete with an en suite shower room.

DOYLE TWO / THREE BEDROOM HOME

✦ DIMENSIONS

First Floor:

Bedroom 1

3.44m x 2.93m
11'3" x 9'7"

En Suite

Bedroom 2

2.69m x 3.10m
8'10" x 10'2"

Bed 3 / Study

1.99m x 2.05m
6'6" x 6'9"

Bathroom

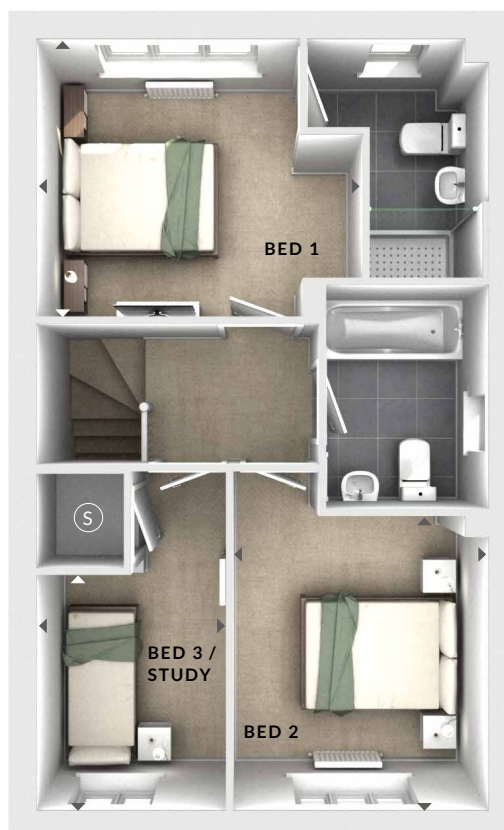

First Floor

Ground Floor:

Lounge

3.75m x 4.38m
12'3" x 14'5"

Kitchen / Dining

3.63m x 3.69m
11'11" x 12'1"

(U) Utility

(S) Storage

(C) Cloaks

◄ ► Measurement Points

△ External Access

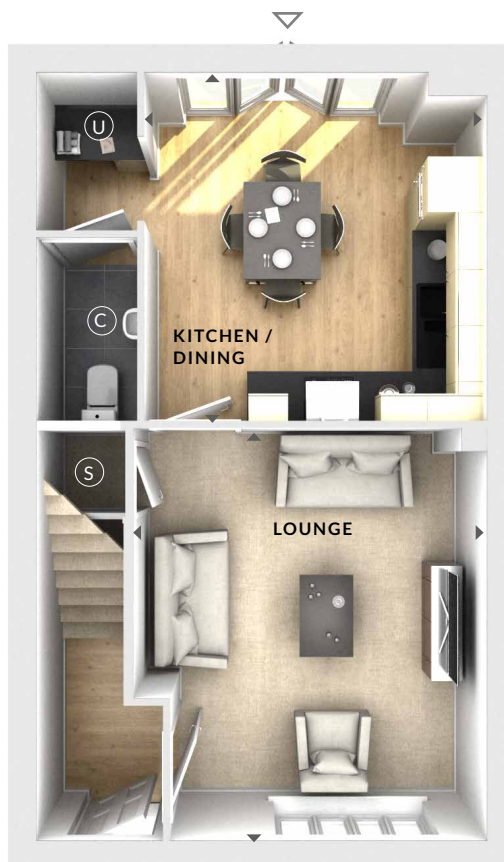

Ground Floor