



3 Floors



4 Bedrooms



Utility



2 En suites

MABBE FOUR BEDROOM HOME

A four bedroom detached family home offering a charming lounge and open plan kitchen / dining area with French doors leading to the rear garden. Downstairs also comprises a convenient utility cupboard and cloakroom. The master suite occupies the whole of the second floor and includes an en suite shower room and fitted wardrobes.

MABBE FOUR BEDROOM HOME

✦ DIMENSIONS

Second Floor:

Bedroom 1

6.17m x 4.12m
20'3" x 13'6"

En Suite

First Floor:

Bedroom 2

3.78m x 3.15m
12'5" x 10'4"

En Suite

Bedroom 3

3.42m x 3.05m
11'3" x 10'0"

Bedroom 4

2.71m x 2.28m
8'11" x 7'6"



First Floor

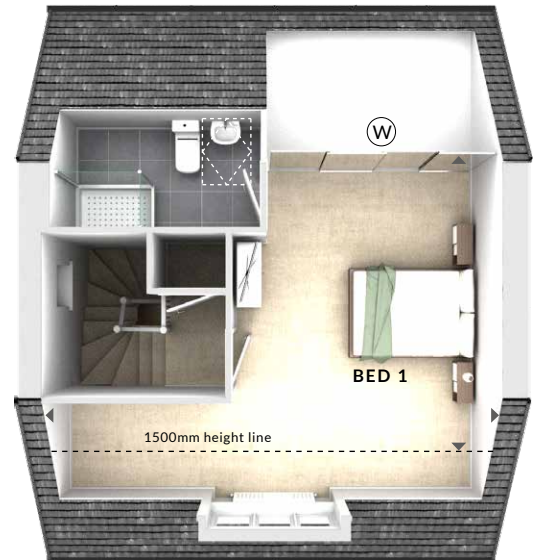

Second Floor

Ground Floor:

Lounge

3.36m x 4.61m
11'0" x 15'2"

Kitchen / Dining

6.20m x 3.11m
20'4" x 10'3"

(U) Utility

(C) Cloaks

(W) Wardrobes

(S) Storage

◀ ▶ Measurement Points

△ External Access



Ground Floor