



2 Floors



2 Bedrooms



Utility

DACRE ONE / TWO BEDROOM HOME

A one / two bedroom terraced home with a perfectly proportioned lounge and a stunning open plan kitchen / dining room with a separate utility area, cloakroom and French doors opening onto the rear garden. Upstairs is home to the family bathroom and two spacious double bedrooms with the second bedroom also being used as a study.

DACRE **ONE / TWO** **BEDROOM** **HOME**

✦ **DIMENSIONS**

First Floor:

Bedroom 1

4.22m x 2.81m
 13'10" x 9'3"

Bedroom 2 / Study

4.22m x 2.50m
 13'10" x 8'2"

Bathroom

Ground Floor:

Lounge

3.21m x 4.17m
 10'6" x 13'8"

Kitchen / Dining

3.09m x 3.01m
 10'2" x 9'10"

Utility

1.05m x 1.70m
 3'5" x 5'7"

(S) Storage

(C) Cloaks

◀▶ Measurement Points

△ External Access

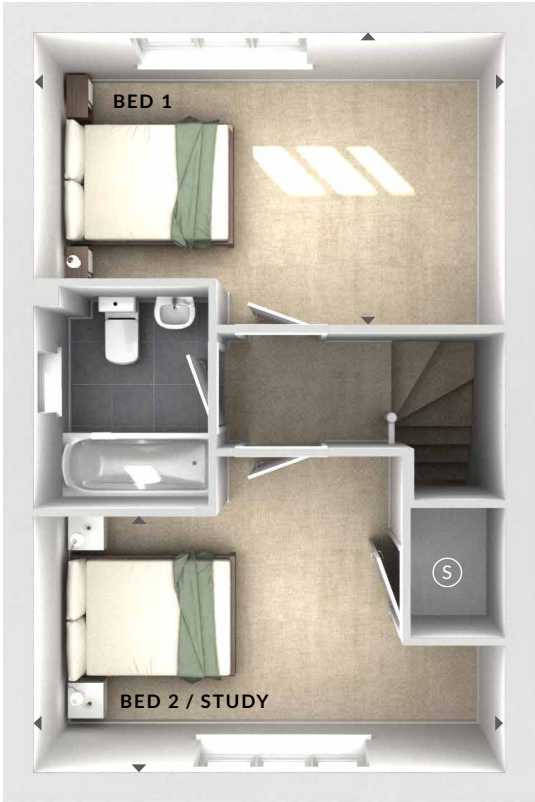

First Floor



Ground Floor