



CORRINGWAY

LONDON, NW11 7EF

£650,000
LEASEHOLD

We are pleased to present for sale a rare opportunity to live in this elegant, bright and spacious two bedroom, two bathroom apartment building on the first floor with porter, lift and gated underground car parking.

Heathview Court is only minutes walk away from Golders Green underground station and the beautiful Hampstead Heath extension, positioning itself in a peaceful and quiet suburb.

Located on the first floor of this sought after apartment building, this front facing two double bedroom, two bathroom flat offers a light and spacious living accommodation with a separate eat in kitchen.

The property comes with a secure, dedicated underground car parking space that is gated, enabling immediate access to the block.



TAYLOR HAWKINS
Estate Agents
0208 958 2222 / TaylorHawkins.co.uk

First Floor

Approx. 88.5 sq. metres (952.7 sq. feet)

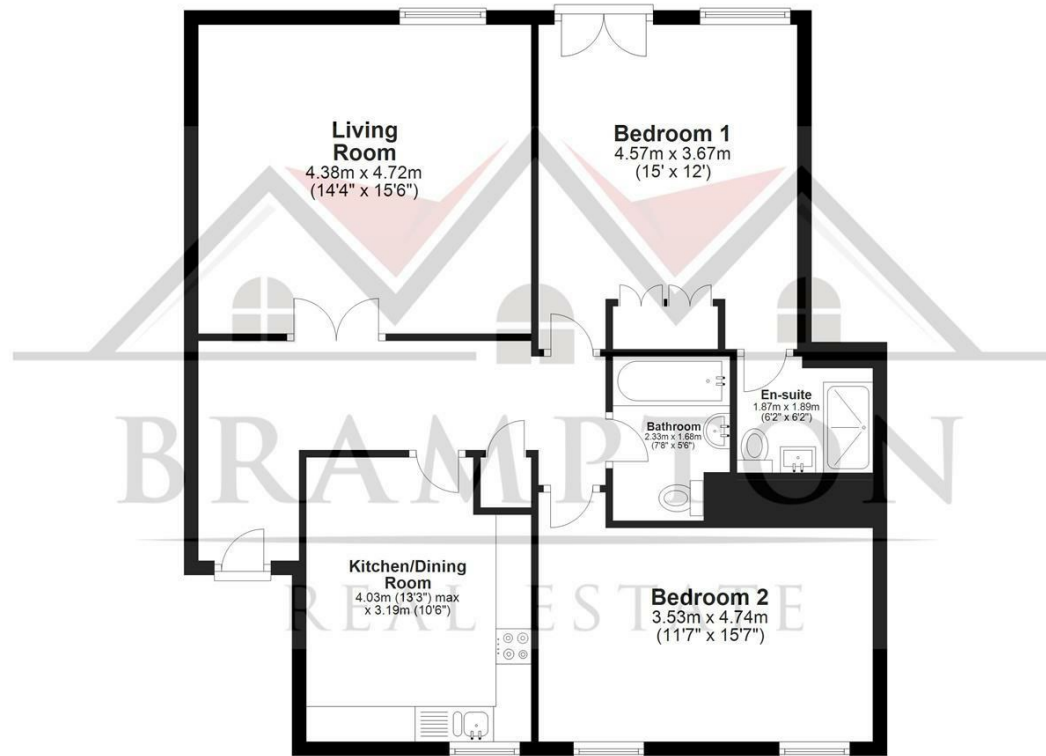

Total area: approx. 88.5 sq. metres (952.7 sq. feet)

Floor Plan measurements are approximate and are for illustrative purposes only. While we do not doubt the floor plans accuracy, we make no guarantee, warranty or representation as to the accuracy and completeness of the floor plan.
Plan produced using PlanUp.

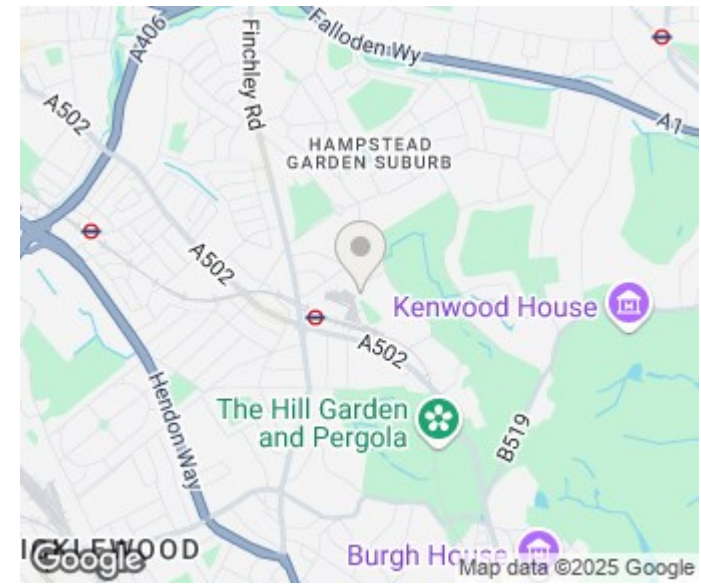

Energy Efficiency Rating		
	Current	Potential
Very energy efficient - lower running costs		
(92 plus) A		
(81-91) B		
(69-80) C		
(55-68) D		
(39-54) E		
(21-38) F		
(1-20) G		
Not energy efficient - higher running costs		
England & Wales	EU Directive 2002/91/EC	

Agents Note: Whilst every care has been taken to prepare these particulars, they are for guidance purposes only. All measurements are approximate and are for general guidance purposes only and whilst every care has been taken to ensure their accuracy, they should not be relied upon and potential buyers/tenants are advised to recheck the measurements

Edgware Sales
58 Edgware Way
Edgware
Middlesex
HA8 8DJ

020 8958 2222
property@taylorhawkins.co.uk
<https://taylorhawkins.co.uk/>



TAYLOR HAWKINS
Estate Agents
0208 958 2222 / TaylorHawkins.co.uk