



## CURTON CLOSE

EDGWARE, HA8 8GU

**£120,000**  
**LEASEHOLD**

Taylor Hawkins proudly presents this stunning new-build, two-bedroom shared ownership apartment on the first floor, offering a 25% share in the property with the ability to staircase up to 100% ownership over time. Located within a well-maintained, gated community, it includes a designated parking spot and access to a lift. The apartment is spacious and filled with natural light, featuring a modern design and a large balcony—perfect for dining or simply relaxing. With ample storage throughout, this home is both practical and stylish. Conveniently situated near shops, schools, and public transport, it offers excellent local amenities and connectivity. To arrange a viewing, please contact us at 0208 958 2222. Don't miss out on this exceptional opportunity!



**TAYLOR HAWKINS**  
Estate Agents  
0208 958 2222 / [Taylor-hawkins.co.uk](http://Taylor-hawkins.co.uk)

# Curton Close, Edgware, HA8

Approximate Area = 672 sq ft / 62.4 sq m  
For identification only - Not to scale

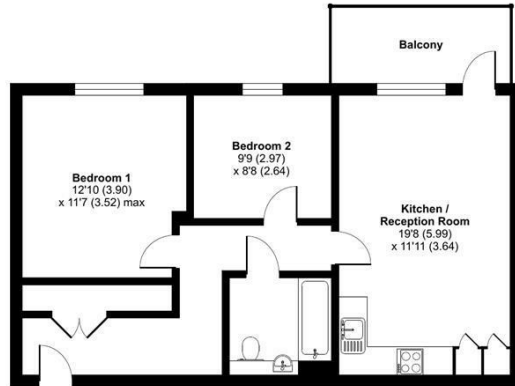

FIRST FLOOR

Floor plan produced in accordance with RICS Property Measurement Standards incorporating International Property Measurement Standards (IPMS2 Residential). © ricscom 2024. Produced for Taylor Hawkins. REF: 1169864



Energy Efficiency Rating		
	Current	Potential
Very energy efficient - lower running costs		
(92 plus) <b>A</b>		
(81-91) <b>B</b>	<b>86</b>	<b>86</b>
(69-80) <b>C</b>		
(55-68) <b>D</b>		
(39-54) <b>E</b>		
(21-38) <b>F</b>		
(1-20) <b>G</b>		
Not energy efficient - higher running costs		
<b>England &amp; Wales</b>	EU Directive 2002/91/EC	

Agents Note: Whilst every care has been taken to prepare these particulars, they are for guidance purposes only. All measurements are approximate and are for general guidance purposes only and whilst every care has been taken to ensure their accuracy, they should not be relied upon and potential buyers/tenants are advised to recheck the measurements

Edgware Sales  
58 Edgware Way  
Edgware  
Middlesex  
HA8 8DJ

020 8958 2222  
property@taylorhawkins.co.uk  
<https://taylorhawkins.co.uk/>



**TAYLOR HAWKINS**  
Estate Agents  
0208 958 2222 / Taylorhawkins.co.uk