



## 2 Glenfor

Abergele, LL22 8EX

**£260,000**



# 2 Glenfor

Abergele, LL22 8EX

**£260,000**



## **Porch**

## **Living Room**

19'10" x 11'4" (6.06m x 3.47m )

## **Dining Room**

10'10" x 7'10" (3.31m x 2.40m )

## **Kitchen**

11'9" x 7'10" (3.60m x 2.39m )

## **Hall**

## **Bedroom One**

13'1" x 11'1" (4.01m x 3.40m )

## **Bedroom Two**

11'5" x 9'6" (3.48m x 2.92m )

## **Shower Room**

6'6" x 5'6" (2.00m x 1.70m )

## **External & Garage**

16'8" x 16'8" (5.10m x 5.10m)

Outside, a driveway leads to the double garage, complete with lighting and power, while the south facing rear garden showcases a low-maintenance private garden bathed in the warmth of the sun



## Road Map



## Hybrid Map



## Terrain Map



## Floor Plan

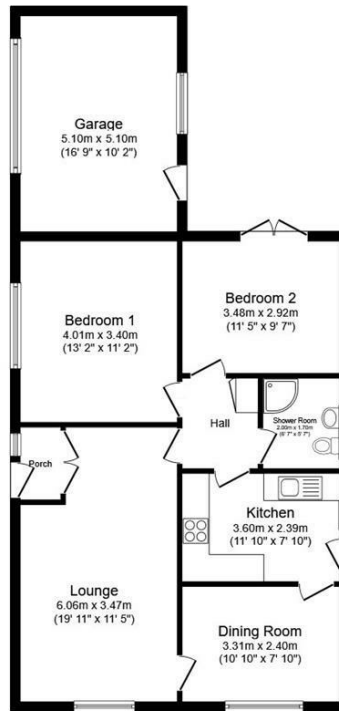

### Floor Plan

Floor area 88.9 m<sup>2</sup> (956 sq.ft.)

TOTAL: 88.9 m<sup>2</sup> (956 sq.ft.)

This floor plan is for illustrative purposes only. It is not drawn to scale. Any measurements, floor areas (including any total floor area), openings and orientations are approximate. No details are guaranteed, they cannot be relied upon for any purpose and do not form any part of any agreement. No liability is taken for any error, omission or misstatement. A party must rely upon its own inspection(s). Powered by www.Propertybox.io

## Viewing

Please contact our Idris Estates Head Office Office on 01745 630322 if you wish to arrange a viewing appointment for this property or require further information.

## Energy Efficiency Graph

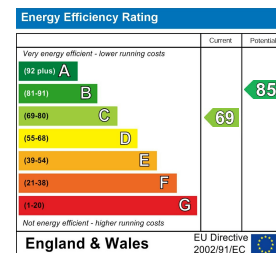

These particulars, whilst believed to be accurate are set out as a general outline only for guidance and do not constitute any part of an offer or contract. Intending purchasers should not rely on them as statements of representation of fact, but must satisfy themselves by inspection or otherwise as to their accuracy. No person in this firm's employment has the authority to make or give any representation or warranty in respect of the property.