



Gannock Park

Deganwy, Conwy, LL31 9PZ

£975,000



Gannock Park

Deganwy, Conwy, LL31 9PZ

£975,000



Occupying approximately 0.5 acres, the residence is accessed via a private drive, creating a retreat-like ambiance that ensures seclusion from the road, enveloping the property in a cocoon of privacy. The expansive driveway and garage efficiently cater to practical parking needs. Meticulously tended by the current owner, the enchanting gardens feature mature trees, vibrant flowers, and various shrubs, with secret areas of interest that wildlife cherishes, enhancing the overall allure of the property.

Deganwy entices with its array of boutique shops, fine dining establishments, and an upscale marina featuring its own luxurious hotel and spa. Positioned along one of North Wales' captivating coastlines, this charming village lies between the renowned towns of Llandudno and Conwy on the picturesque banks of the Conwy Estuary. With inviting beaches and scenic coastal walks, Deganwy serves as a haven for those seeking the perfect fusion of natural beauty and refined living. Set against the backdrop of the Conwy Estuary, the location ensures an abundance of sunlight, casting a golden glow on the surroundings and accentuating the area's most spectacular sunsets.

In this idyllic setting, the residence becomes a perfect retreat for those who appreciate the harmonious blend of luxurious living and the splendors of the natural world.

First Floor Entrance Hall

Lounge

17'11" x 13'11" (5.47m x 4.26m)

Dining Room

13'11" x 13'1" (4.25m x 4.00m)

Sitting Room

11'5" x 11'1" (3.48m x 3.40m)

Kitchen

12'10" x 10'4" (3.93m x 3.15m)

Conservatory

13'5" x 9'6" (4.09m x 2.90m)

Toilet

Bathroom

7'5" x 8'8" (2.27m x 2.65m)

Downstairs to the lower level

Lounge/Study

13'9" x 8'11" (4.21m x 2.72m)

Kitchenette

13'9" x 8'7" (4.21m x 2.62m)

Toilet

Shower Room

Upstairs to the second floor

Bedroom One

15'9" x 13'7" (4.81m x 4.16m)

Bedroom Two

13'1" x 10'4" (4.01m x 3.15m)

Bathroom

7'8" x 4'5" (2.36m x 1.36)

Garage

18'5" x 13'0" (5.63m x 3.97m)

External

These enchanting grounds of Gannock Park, where the gardens sprawl across 0.5 acres. Designed for both exploration and relaxation, immerse yourself in captivating views and the tranquil presence of

the Vadre, elevating the outdoor experience to a realm of serene beauty. Wander through this botanical haven, a tapestry of natural wonders, and discover a small orchard that adds a touch of bucolic charm to the landscape. The garden features a charming ornamental pond, creating a pleasant environment for local wildlife.



Road Map



Hybrid Map



Terrain Map



Floor Plan

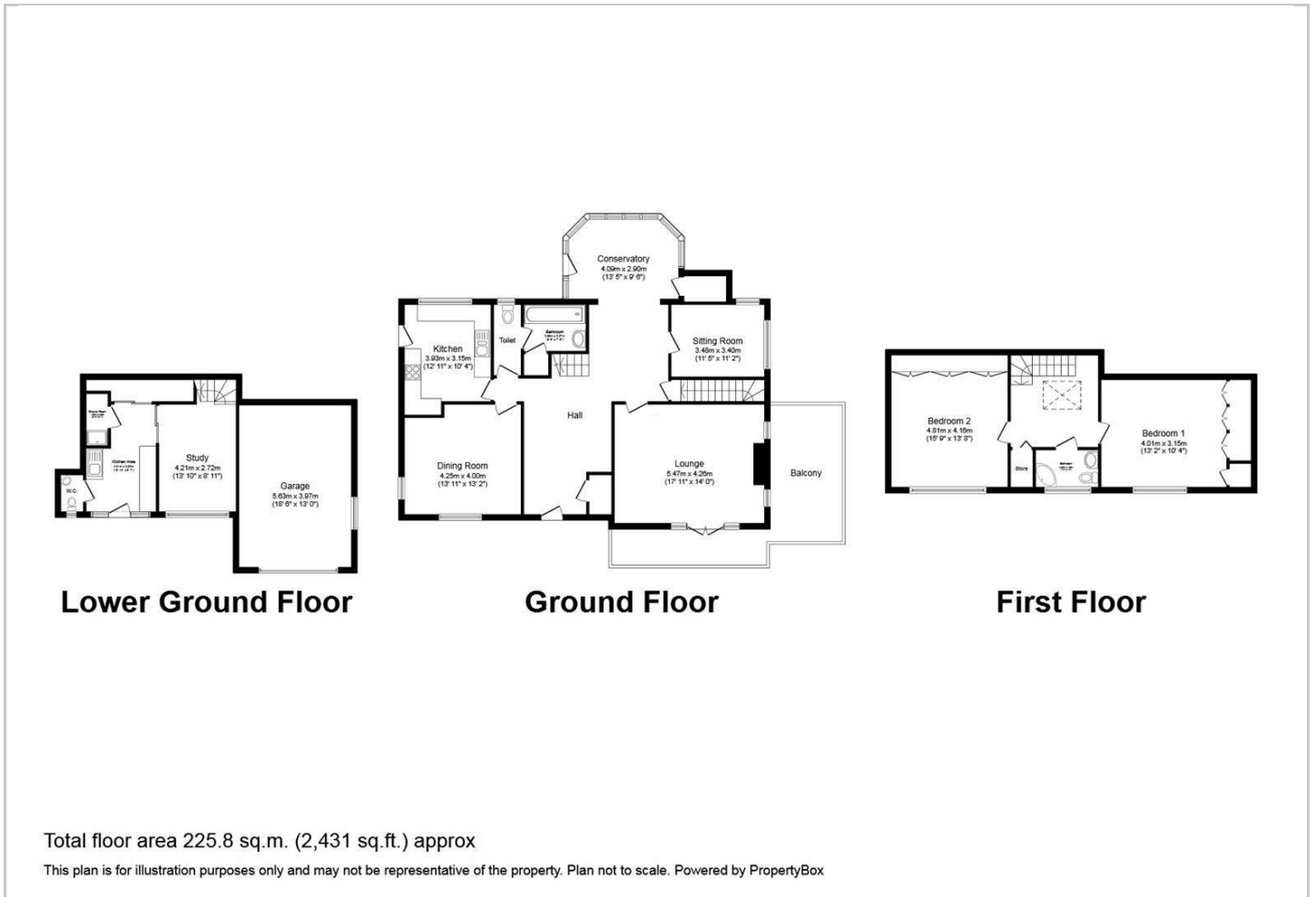

Viewing

Please contact our Idris Estates Head Office Office on 01745 630322 if you wish to arrange a viewing appointment for this property or require further information.

Energy Efficiency Graph

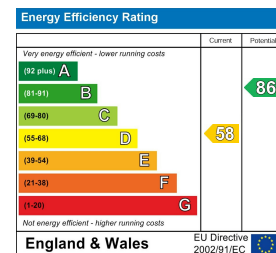

These particulars, whilst believed to be accurate are set out as a general outline only for guidance and do not constitute any part of an offer or contract. Intending purchasers should not rely on them as statements of representation of fact, but must satisfy themselves by inspection or otherwise as to their accuracy. No person in this firm's employment has the authority to make or give any representation or warranty in respect of the property.