

28 School Road
Necton
PE37 8HT



ATTIK
CITY | COUNTRY | COAST

28 School Road

£485,000

The detached bungalow on a substantial plot

Nestled in the village of Necton, School Road is a delightful family home offering a perfect blend of comfort and style. Benefiting from a scenic field view and a tranquil setting, this property is approached through elegant electric gates and a handsome brick wall, providing both security and privacy. The expansive driveway accommodates ample parking and is adorned with thoughtfully raised planting beds. The front garden invites you in with its lush greenery and established trees.

Access to the property is through a side door leading into a bright and spacious conservatory. Through the conservatory, you step into a welcoming kitchen and dining area, featuring wood-effect worktops complemented by cream cabinetry and stylish wooden handles. The kitchen is equipped with modern conveniences including an integrated slimline dishwasher, oven, hob and a sink with views over the rear garden.

Leading off the kitchen is a welcoming hallway. To the left, the main family shower room boasts contemporary fixtures, including a spacious walk-in corner shower complete with a heated towel rail and a vanity unit housing the sink and toilet, it offers both function and style.

Adjacent to the shower room is bedroom two, a generous double room with garden views, perfect for relaxation. Following through, you will find bedroom three, which, while slightly smaller, remains a comfortable space that can accommodate a double bed. At the end of the hallway, bedroom one features large window with views of the garden, creating a serene atmosphere.

The living room is bathed in natural light and features two large windows overlooking the front of the property, as well as a charming feature fireplace, making it an inviting space for family gatherings.

Outdoors, a substantial carport offers shelter for up to three vehicles. The extensive garden area is bordered by fencing, providing a safe haven for pets and children alike. With a spacious lawn, mature planting and a serene pond, this garden is a delightful space for outdoor living.

Further down the property, discover large versatile outbuildings—ideal for storage or hobby spaces. Currently housing a hot tub, one of these rooms makes for a splendid summer retreat. This property at School Road is an excellent opportunity for families looking for a harmonious blend of indoor comfort and outdoor space in the heart of Necton.

Agents notes...

A pre-recorded walkaround tour is available for this property
Council Tax Band C

Local Authority
Breckland

Council Tax Band C

EPC Rating A



GROUND FLOOR
2843 sq.ft. (264.1 sq.m.) approx.

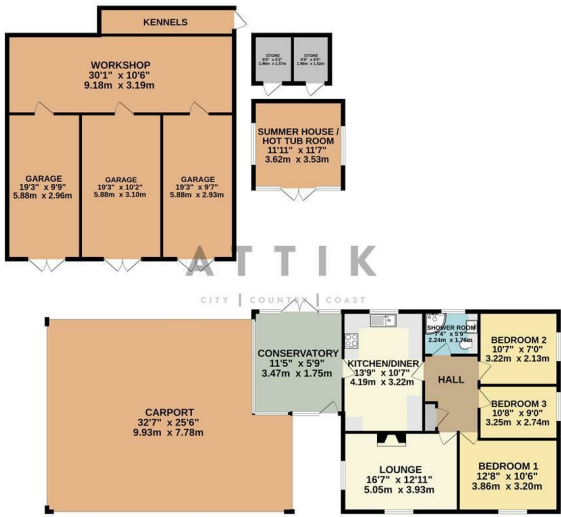

TOTAL FLOOR AREA: 2843 sq.ft. (264.1 sq.m.) approx.
While every effort has been made to ensure the accuracy of the floorplan contained here, measurements of floors, walls, doors and windows should always be taken on site and not relied upon for any legal or financial purposes. The actual area of the property may vary slightly from the measurements given. The actual area of the property may vary slightly from the measurements given. The actual area of the property may vary slightly from the measurements given.