

8 Blyth Mews  
Halesworth  
IP19 8FB



**ATTIK**  
CITY | COUNTRY | COAST

# 8 Blyth Mews

## Guide Price £425,000

### A well presented 4 bedroom property...

Introducing 8 Blyth Mews, a spacious and well-appointed residence situated in the vibrant town of Halesworth. This attractive property is conveniently located within a short stroll of the town centre, offering an array of shops, cafés, and amenities. The picturesque landscapes surrounding Halesworth provide ample opportunities for outdoor enthusiasts, with walking paths and green spaces, including the adjacent Millennium Green.

As you approach the property, you will appreciate its distinctive façade and private front garden, which is bordered by lush hedging for added privacy. The welcoming entrance leads to a generous hallway and flows into a beautifully extended kitchen, dining, and family room. This versatile space is ideal for both relaxing and entertaining, featuring a stylish fitted kitchen with high-quality hardwood worktops, a breakfast bar, and seamless access to the charming private courtyard garden.

The garden area is designed for relaxation and enjoyment, featuring a patio suitable for al fresco dining, a covered bar space, and even a small putting green for leisure activities. The utility room conveniently adjoins the kitchen and provides practical storage solutions, alongside access to the garage.

The lounge is a spacious dual-aspect room, flooded with natural light, providing a lovely living space that complements the well-thought-out design of the home. The property boasts four bedrooms, including a generous master suite with an en-suite shower room, and ample wardrobe space in every room.

The bathroom features modern fittings, ensuring comfort and convenience for all household members and visitors.

Ideal for families or individuals seeking a tranquil lifestyle with easy access to local amenities and stunning coastal scenery, 8 Blyth Mews presents an exceptional opportunity to enjoy the best of Halesworth living. With the coast just a short drive away, it's perfectly positioned for those who appreciate both the charms of town life and the beauty of the Suffolk coastline.

Don't miss your chance to make this wonderful property your new home.

### Agents notes...

A pre-recorded walkaround tour is available for this property

A service charge of £175.33 p/a applies for general grounds maintenance

Local Authority  
East Suffolk

Council Tax Band C

EPC Rating C

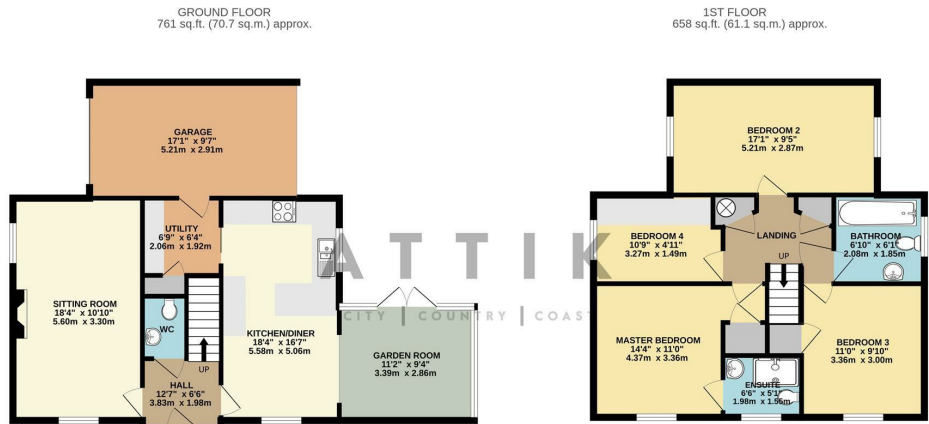

TOTAL FLOOR AREA: 1419 sq.ft. (131.8 sq.m.) approx.

Whilst every attempt has been made to ensure the accuracy of the floorplan contained here, measurements of doors, windows, rooms and any other items are approximate and no responsibility is taken for any error, omission or mis-statement. This plan is for illustrative purposes only and should be used as such by any prospective purchaser. The services, systems and appliances shown have not been tested and no guarantee as to their operability or efficiency can be given.

Made with Metropix ©2025