



Umberville Way

Slough SL2

Asking Price £399,995



C

# Umberville Way Slough SL2



## Summary Description

Guide Price £399,995 - £424,995. Three Bed End Of Terrace, Front & Rear Gardens, Modernised Kitchen & Bathroom, Open plan Living. Double Glazed and Gas Central Heating.

Three Bedroom

Front & Rear Gardens

Modern Family Bathroom

Well Presented

With Or Without Tenant

End Of Terrace Property

Open Plan Living /Dining Room/  
Kitchen

Modern Kitchen

South Facing Rear Garden





## Floor Plan

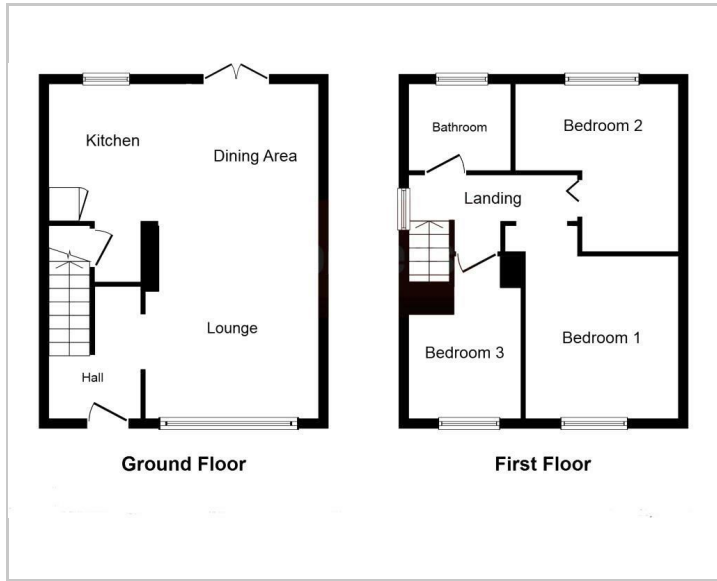

## Area Map

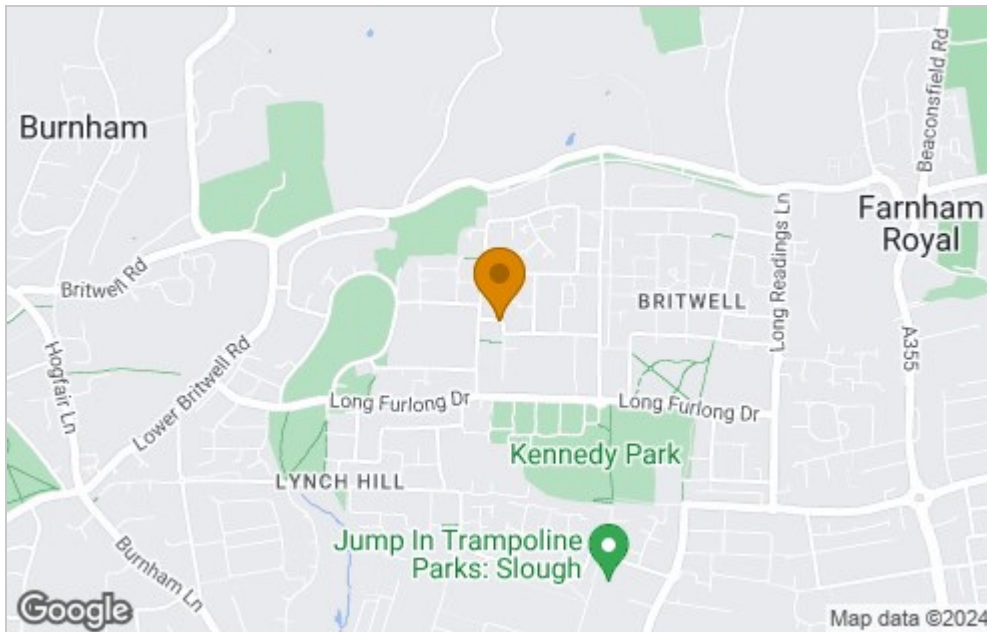

## Energy Efficiency Graph

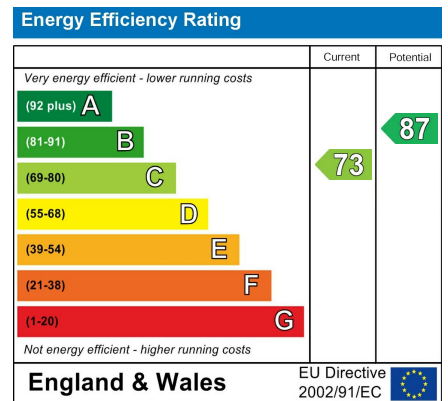

Council Tax Band:

## Viewing

Please contact our Burnham Office on 01753 255 755 if you wish to arrange a viewing appointment for this property or require further information.

These particulars, whilst believed to be accurate are set out as a general outline only for guidance and do not constitute any part of an offer or contract. Intending purchasers should not rely on them as statements of representation of fact, but must satisfy themselves by inspection or otherwise as to their accuracy. No person in this firm's employment has the authority to make or give any representation or warranty in respect of the property.