



Duncan Terrace

Angel, N1

£3,150 Per Month

£3,634 Deposit

Available from: 20th November 2024

Superb flat located on a quiet residential street close to Angel tube station. The accommodation is set over two floors and with a large bedroom on the upper level and expansive open plan kitchen/living space on the lower level, with the added benefit of two bathrooms, an extra reception area on the upper floor and a private garden.

Moments from all the amenities of Upper Street and Islington High Street and the bus routes on City Road.

Available: 20th November.

- Prime Location Angel
- Private Garden
- Open plan living space
- Two bathrooms
- 1171 square feet
- Close to all amenities
- Council Tax: Band F

Viewing

Please contact our Upper Street Office on 020 7871 4444 if you wish to arrange a viewing appointment for this property or require further information.



Additional Information

Heating: Gas central heating

Electricity: Mains

Water: Mains

Sewerage: Mains

Broadband: Predicted Standard & Ultrafast (Ofcom)

Mobile signal/coverage: Predicted Likely for EE, Three, O2 & Vodafone (Ofcom)

Parking: Street Parking Permits available from local authority

Floor Plan

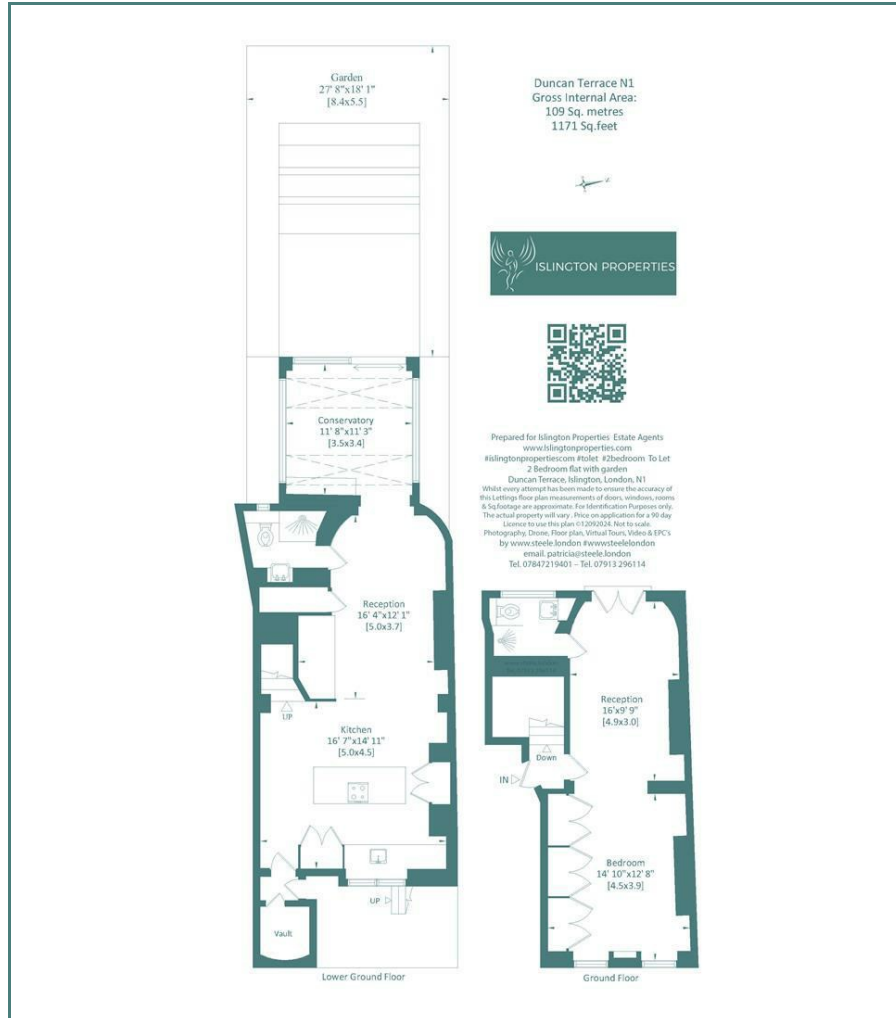

Area Map



Energy Efficiency Graph

Energy Efficiency Rating

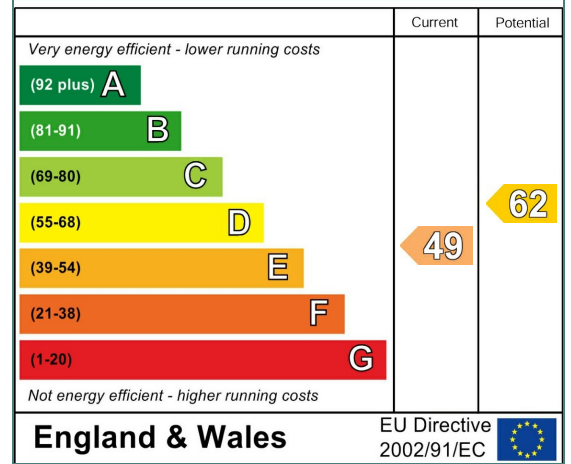

These particulars, whilst believed to be accurate are set out as a general outline only for guidance and do not constitute any part of an offer or contract. Intending purchasers should not rely on them as statements of representation of fact, but must satisfy themselves by inspection or otherwise as to their accuracy. No person in this firm's employment has the authority to make or give any representation or warranty in respect of the property. Council Tax and tenancy information should be confirmed with the Lettings Manager prior to the signature of the tenancy agreement.