



ISLINGTON PROPERTIES



Rawstorne Street Clerkenwell, EC1V £2,800 Per Month £3,230 Deposit

Two bedroom apartment located within this development close to Angel station and local bus routes. The flat is located on a quiet street and offers outside space by way of a south easterly aspect patio garden and a large communal roof terrace, with local amenities within walking distance.

- Central location
- Bike storage facility
- Private garden
- Modern bathroom
- Superb transport options
- Close to local amenities
- Council tax: C

Viewing

Please contact our Upper Street Office on 020 7871 4444 if you wish to arrange a viewing appointment for this property or require further information.



2



1



1



D

Additional Information

Heating: Gas central heating

Electricity: Mains

Water: Mains

Sewerage: Mains

Broadband: Standard, Superfast & Ultrafast (Ofcom)

Mobile: Good for EE, Three, O2 & Vodafone (Ofcom)

Parking: Street resident parking permit can be purchased from the council

Floor Plan

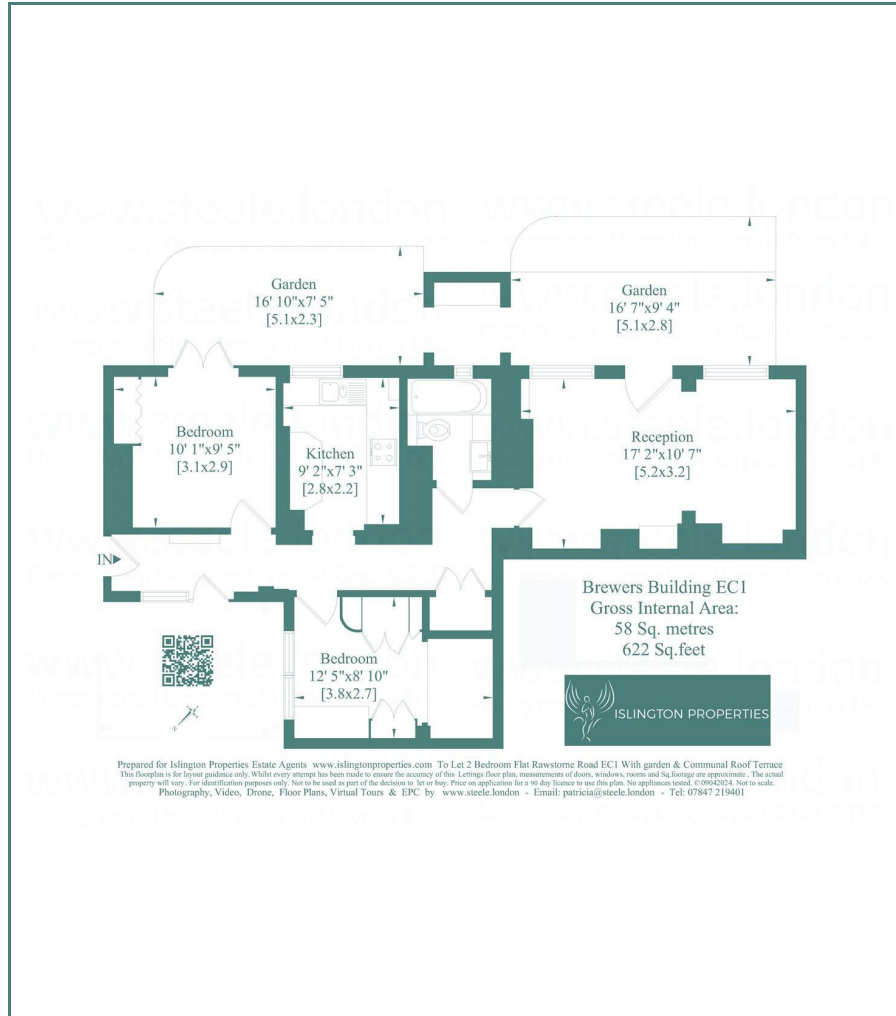

Area Map



Energy Efficiency Graph

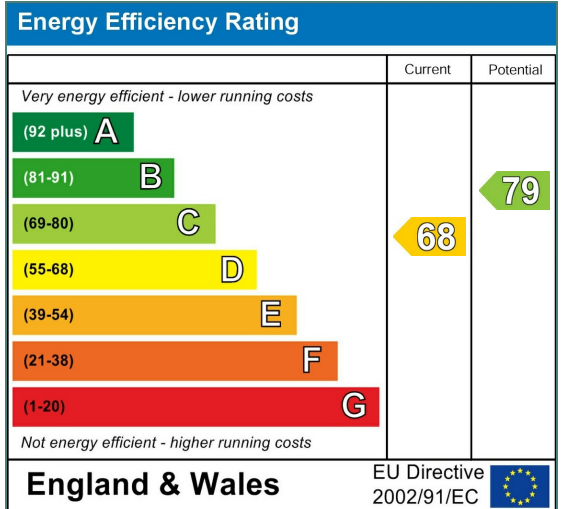

These particulars, whilst believed to be accurate are set out as a general outline only for guidance and do not constitute any part of an offer or contract. Intending purchasers should not rely on them as statements of representation of fact, but must satisfy themselves by inspection or otherwise as to their accuracy. No person in this firm's employment has the authority to make or give any representation or warranty in respect of the property. Council Tax and tenancy information should be confirmed with the Lettings Manager prior to the signature of the tenancy agreement.