



**Russet Court, Coxheath, Maidstone, Kent, ME17 4PQ**  
**Price £120,000**



**\*\*\*NO FORWARD CHAIN\*\*\*SPACIOUS ONE-BEDROOM GROUND FLOOR RETIREMENT APARTMENT IN SOUGHT-AFTER COXHEATH LOCATION**

Located in the heart of the popular village of Coxheath, this generously proportioned ground-floor apartment is just a short walk from a range of local amenities, including a doctors' surgery, Lloyds Pharmacy, and Londis convenience store. Maidstone town centre, offering a wider selection of shops and leisure facilities, is only a short drive away, with a regular bus service every 20 minutes for easy access.

Exclusively available to those aged 55 and over, the apartment features well-designed accommodation comprising a welcoming entrance hall, a double bedroom, bathroom, a spacious living room, and a fully fitted kitchen. The property is part of a well-maintained retirement complex that offers on-site parking, beautifully kept communal gardens, and the reassurance of a warden assisted manager. Each apartment is also equipped with a 24 hour medical alarm system for added peace of mind.

If you're seeking a bright and comfortable retirement home in a friendly and convenient setting, don't miss out—contact Page & Wells Loose Office today on 01622 746273 to arrange your viewing.



Lounge/Dining Room 21'0" x 17'6" (6.42m x 5.35m)

Kitchen 13'9" x 6'11" (4.20m x 2.12m)

Bedroom 13'2" x 10'1" (4.02m x 3.08m)

Bathroom

### Energy Efficiency Rating

	Current	Potential
Very energy efficient - lower running costs		
(92 plus) <b>A</b>		
(81-91) <b>B</b>		
(69-80) <b>C</b>	<b>71</b>	<b>78</b>
(55-68) <b>D</b>		
(39-54) <b>E</b>		
(21-38) <b>F</b>		
(1-20) <b>G</b>		
Not energy efficient - higher running costs		
<b>England &amp; Wales</b>	EU Directive 2002/91/EC	

Page & Wells limited for themselves and for the vendors of this property whose agents they are give notice that: 1. These particulars do not constitute any part of, an offer or a contract. 2. All statements contained in these particulars as to this property are made without responsibility on the part of Page & Wells Limited or the Vendor. 3. None of the statements contained in these particulars as to the property is to be relied on as statements or representations of fact. 4. Any intending purchaser must satisfy himself by inspection or otherwise as to the correctness of each of the statements contained in these particulars. 5. The vendor does not make or give, and neither Page & Wells Limited nor any person in their employment has any authority to make or give any representation whatsoever in relation to this property. These particulars are supplied on the understanding that all negotiations are carried out throughout Page & Wells Limited. Properties with a reference prefixes EAA are whose which Page & Wells Limited disclose an interest in accordance with the provisions of the Estates Agents Act 1979



Russet Court, Coxheath, Maidstone, Kent  
Approximate Gross Internal Area  
662 Sq Ft/62 Sq M

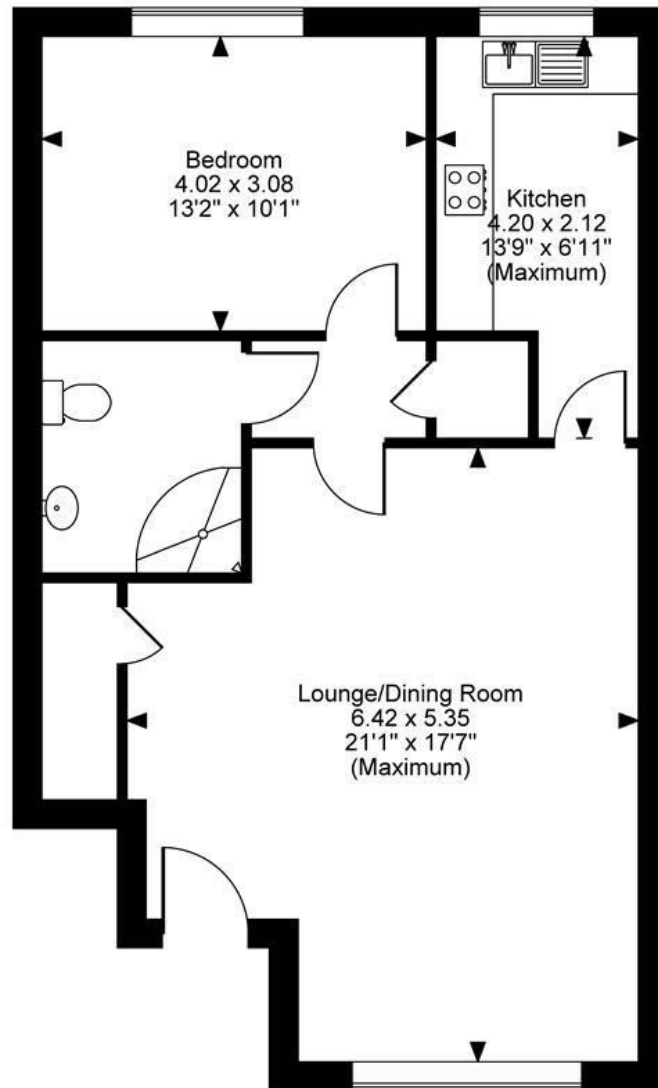
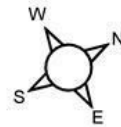

Ground Floor

**FOR ILLUSTRATIVE PURPOSES ONLY - NOT TO SCALE**

The position & size of doors, windows, appliances and other features are approximate only.  
© ehouse. Unauthorised reproduction prohibited. Drawing ref. dig/8644645/TOW

