



The Farrows, Maidstone, ME15 9ZJ
Price £360,000

IMMACULATE THREE BEDROOM TOWN HOUSE IN A POPULAR RESIDENTIAL DEVELOPMENT WITHIN WALKING DISTANCE OF LOCAL AMENITIES AND SOUGHT AFTER SCHOOLS

Nestled in the desirable area of The Farrows, Loose, this immaculate three bedroom family home offers a perfect blend of modern living and comfort. Built in 2013, the home spans an impressive 1,188 square feet. Inside, there is a welcoming hallway, useful ground floor cloakroom, well appointed kitchen with integrated appliances, a spacious lounge area for entertaining and a conservatory currently used as a dining room.

The property offers three generously sized double bedrooms, with the main bedroom on the second floor featuring an ensuite bathroom and fitted wardrobes for added privacy and comfort. The additional two bedrooms are perfect for family members, guests, or even a home office, catering to a variety of lifestyle needs.

Outside, the property benefits from two allocated parking spaces, along with ample visitor parking to the front and a neatly enclosed garden to the rear

This delightful home is not only well-located but also offers a modern lifestyle in a peaceful setting. There are excellent amenities near by including a Sainsbury's Local, as well as sought after Loose Primary School and Tiger Primary School. For the commuter, Staplehurst and Marden Stations are within easy reach providing frequent high speed mainline services to London.

Viewing is highly recommended. Contact Page and Wells Loose Office today and book your viewing to avoid missing out



GROUND FLOOR

Entrance Hall

Kitchen 11'2" x 7'7" (3.42m x 2.33m)

Lounge 15'7" x 14'9" (4.75m x 4.52m)

Dining Area/Conservatory 11'1" x 9'7" (3.39m x 2.94m)

FIRST FLOOR

Bedroom 2 14'9" x 9'6" (4.52m x 2.92m)

Bedroom 3 13'10" x 7'8" (4.24m x 2.36m)

Family Bathroom

SECOND FLOOR

Bedroom 1 17'3" x 11'4" (5.27m x 3.46m)

En-Suite

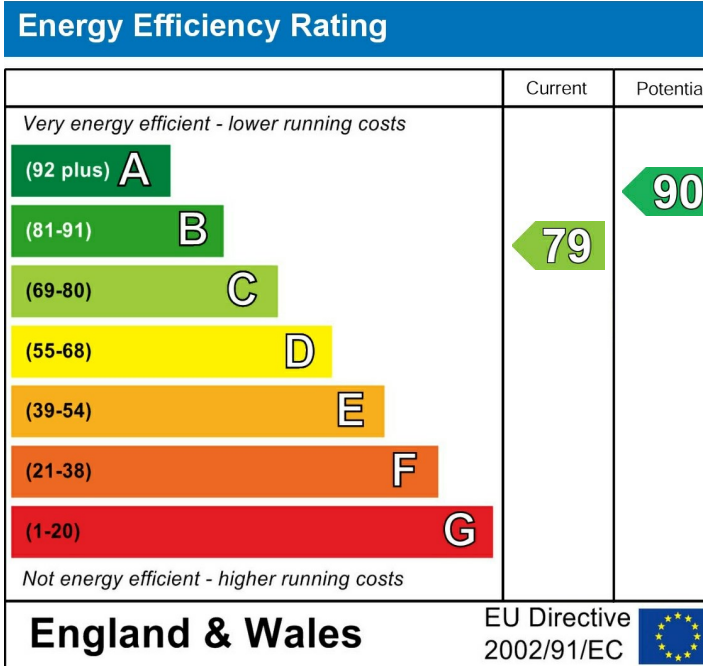

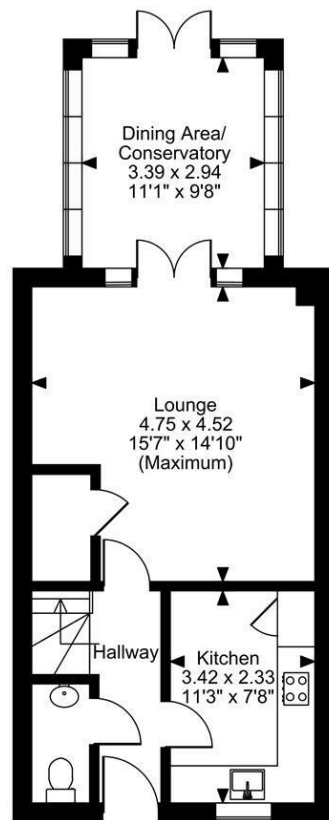

Ground Floor

The Farrows, Maidstone, Kent
Approximate Gross Internal Area
1188 Sq Ft/110 Sq M

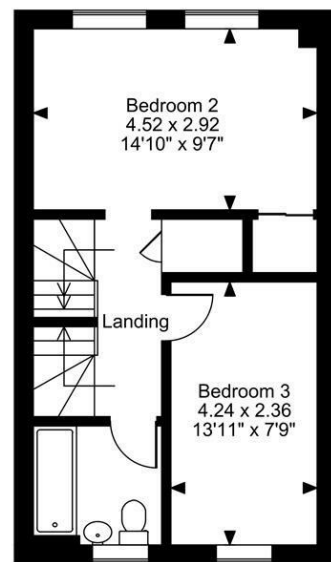
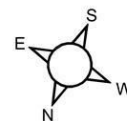

First Floor

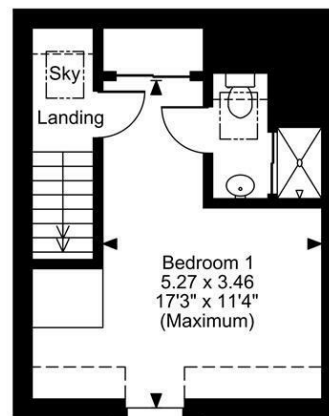

Second Floor

FOR ILLUSTRATIVE PURPOSES ONLY - NOT TO SCALE

The position & size of doors, windows, appliances and other features are approximate only.

□□□ Denotes restricted head height

© ehous. Unauthorised reproduction prohibited. Drawing ref. dig/8638868/SS

