



Furfield Chase, Boughton Monchelsea, Maidstone, ME17 4GD
Offers In Excess Of £325,000

SUPERB 3-BEDROOM FAMILY HOME IN A SOUGHT-AFTER LOCATION WITH WALKING DISTANCE OF LOCAL AMENITIES

This beautifully maintained family home is perfectly positioned within a popular residential development, offering easy access to local amenities and just a 10-minute drive from Maidstone town centre. With excellent transport links, including convenient motorway access and a short drive from Headcorn, Staplehurst and Marden Station for frequent high speed mainline services to London. The home is spread across two well-designed floors. The ground floor features a welcoming entrance hall, a handy downstairs cloakroom, a spacious lounge and a superb kitchen/diner. Upstairs, the principal bedroom benefits from an ensuite shower room, complemented by two further bedrooms and a modern family bathroom. Outside, there is one allocated parking space and the option of off-road parking outside the property. To the rear, there is a neatly enclosed, low-maintenance rear garden with a garden shed, perfect for relaxing or entertaining.

If you're searching for a fantastic family home, call Page & Wells Loose Office on 01622 746273 to arrange your viewing today!



GROUND FLOOR

Entrance Hall

Lounge 14'9" x 12'7" (4.52m x 3.84m)

Kitchen/Dining Area 15'9" x 10'8" (4.82m x 3.27m)

FIRST FLOOR

Bedroom 1 10'6" x 10'4" (3.21m x 3.16m)

En-Suite

Bedroom 2 9'7" x 9'2" (2.94m x 2.81m)

Bedroom 3 7'9" x 6'4" (2.37m x 1.95m)

Family Bathroom

EXTERNALLY

Bike/Garden Store 6'11" x 6'7" (2.11m x 2.02m)

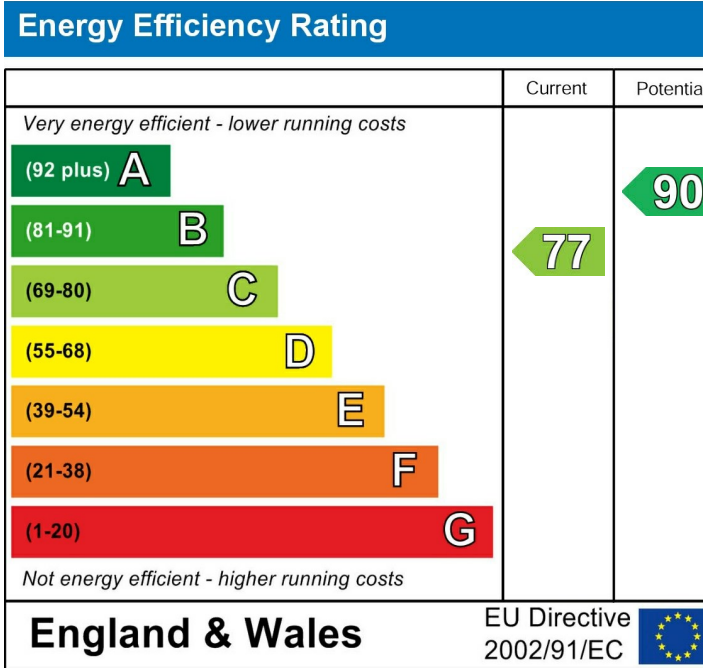

Furfield Chase, Boughton Monchelsea, Maidstone, Kent

Approximate Gross Internal Area

Main House = 838 Sq Ft/78 Sq M

Outbuilding = 46 Sq Ft/4 Sq M

Total = 884 Sq Ft/82 Sq M

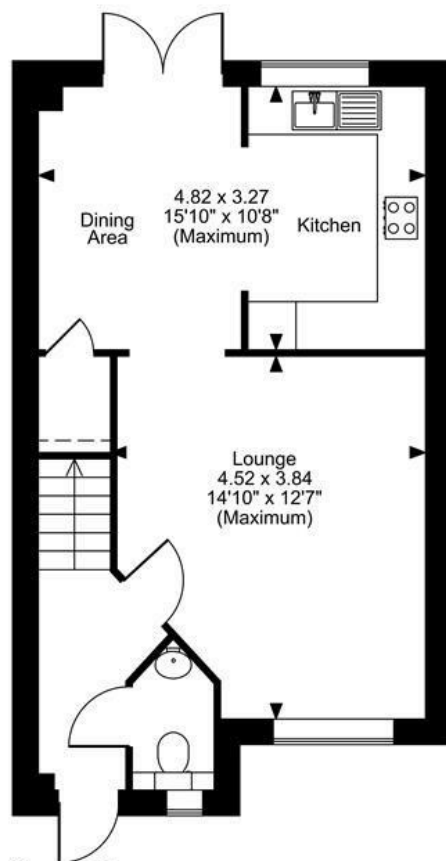
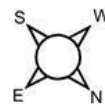

Ground Floor

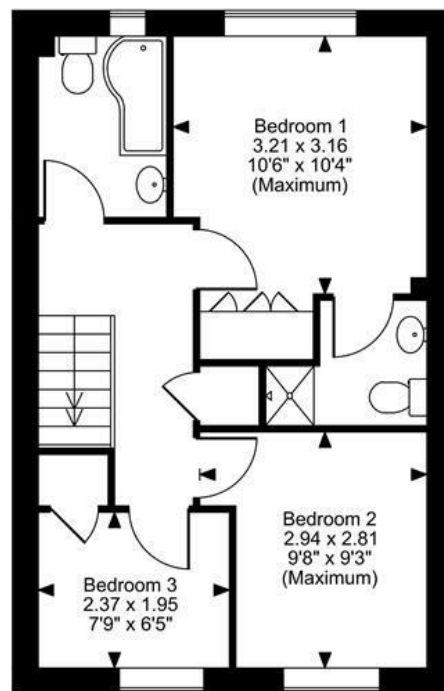

First Floor

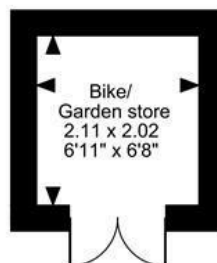

FOR ILLUSTRATIVE PURPOSES ONLY - NOT TO SCALE

The position & size of doors, windows, appliances and other features are approximate only.

□ □ □ Denotes restricted head height

© ehouse. Unauthorised reproduction prohibited. Drawing ref. dig/8633922/LCO

