



**Stratford Drive, Maidstone, ME15 9HJ**  
**Guide Price £350,000**



GUIDE PRICE £350,000 TO £375,000

**\*\*\*NO FORWARD CHAIN\*\*\*FABULOUS THREE BEDROOM HOME IN A QUIET CUL DE SAC POSITION WITH ENSUITE TO THE MAIN BEDROOM, BEAUTIFUL KITCHEN WITHIN WALKING DISTANCE OF LOCAL AMENITIES**

This fabulous property sits in an established residential area with excellent local amenities in walking distance. The town centre itself is easily accessible and provides a wide range of shopping and social facilities, together with two mainline London stations. Headcorn station is about 15-minutes drive from the property with fast regular services to London Charing Cross. Four excellent grammar schools together with the renowned Independent School in Sutton Valence all within a 5-mile radius of the house.

Offering spacious and adaptable accommodation, this fabulous home is located within a quiet cul de sac. On the ground floor there is entrance hall with useful downstairs cloakroom, lounge to the front with glazed internal double doors leading into the dining room, a beautiful kitchen with fitted units completes the ground floor. To the first floor, there is a family bathroom and three bedrooms with an ensuite to the main bedroom.

Outside, the property benefits from ample off road parking to the side of the property. To the rear, a neatly enclosed garden with well stocked borders and decked seating area.

This fabulous family home will generate plenty of interest, so do not delay and call Page and Wells Loose Office and book your viewing today to avoid missing out.



## GROUND FLOOR

### Entrance Hall

Lounge 14'7" x 12'6" (4.46m x 3.82m)

Dining Room 10'8" x 8'1" (3.26m x 2.48m)

Kitchen 10'7" x 7'3" (3.25m x 2.23m)

## FIRST FLOOR

Bedroom 1 10'2" x 9'11" (3.12m x 3.03m)

### En-Suite

Bedroom 2 10'2" x 7'10" (3.10m x 2.39m)

Bedroom 3 7'8" x 6'11" (2.35m x 2.12m)

### Bathroom

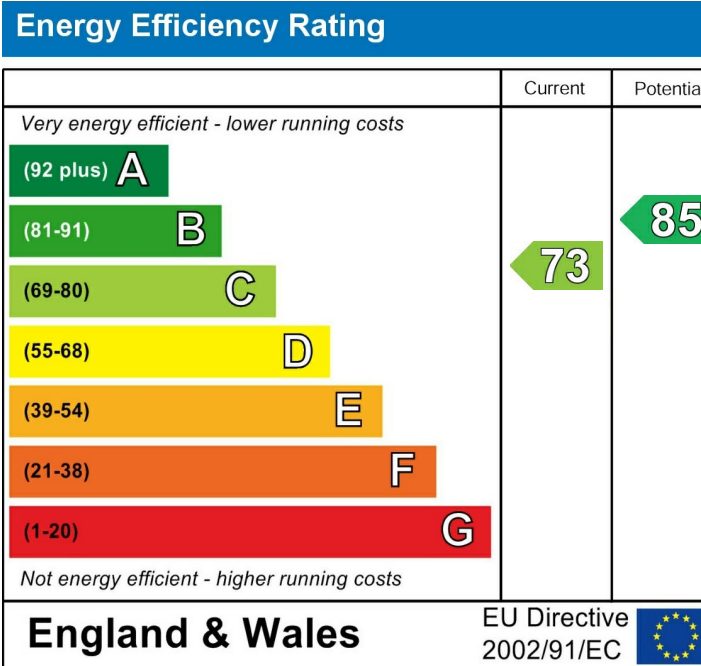



**Stratford Drive, Maidstone, Kent**  
**Approximate Gross Internal Area**  
**811 Sq Ft/75 Sq M**

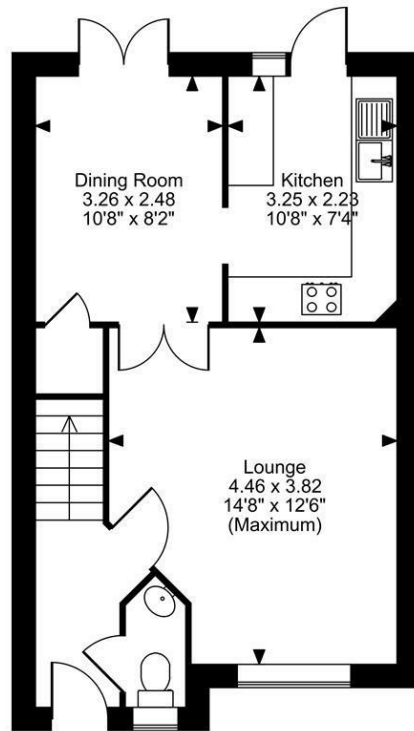

**Ground Floor**

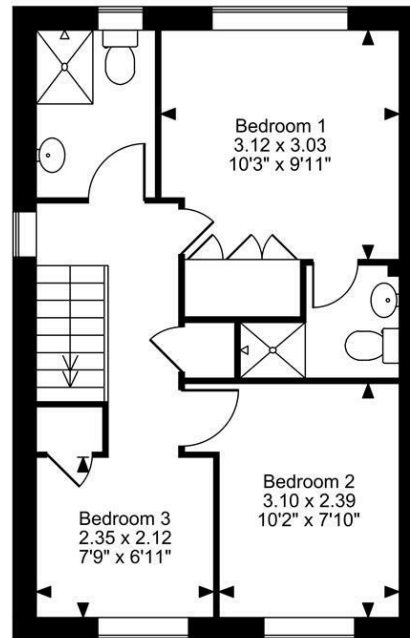

**First Floor**

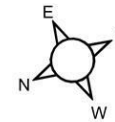

**FOR ILLUSTRATIVE PURPOSES ONLY - NOT TO SCALE**

The position & size of doors, windows, appliances and other features are approximate only.  
 © ehous. Unauthorised reproduction prohibited. Drawing ref. dig/8633640/LCO

