



66 Linden Road, Coxheath, Maidstone, Kent, ME17 4QS
Price £280,000



*****NO FORWARD CHAIN***TWO BEDROOM HOME SITUATED IN A QUIET LOCATION WITHIN WALKING DISTANCE OF LOCAL AMENITIES**

Situated in the sought-after village of Coxheath, this 2-bedroom semi-detached home is in an enviable location nestled in a quiet cul de sac on the south side of Maidstone, Coxheath offers a charming semi-rural setting, with essential amenities such as a primary school, doctors, chemist, and shops just a short stroll away. Maidstone Town Centre is easily accessible by a quick drive or bus ride.

While the property is in need of some interior refurbishment, it offers plenty of scope for modernisation, this delightful property provides ample living space, perfect for first-time buyers or investors alike. On the ground floor there is an entrance porch, lounge/diner, fitted kitchen and conservatory. On the first floor there are two generously sized bedrooms and a well-appointed bathroom. Outside, there are two allocated parking spaces within a designated parking area for residents. Completing the package is neatly enclosed rear garden, perfect for outdoor entertaining.

This excellent home will generate plenty of interest so do not delay and contact Page and Wells Loose Office and book your viewing to avoid missing out.



GROUND FLOOR

Entrance Hall 11'35" x 5'80" (3.35m x 1.52m)

Lounge 13'9" x 11'10"m (4.20m x 3.62mm)

Kitchen 10'11" x 5'6" (3.35m x 1.70m)

Conservatory 7'10" (max) x 9'11" (max) (2.39m (max) x 3.04m (max))

FIRST FLOOR

Bedroom 1 9'2" x 11'10" (max) (2.81m x 3.62m (max))

Bedroom 2 8'11" x 11'10" (2.73m x 3.62m)

Bathroom 6'3" x 5'6" (1.91m x 1.68m)

EXTERNALLY

Two Allocated Parking Spaces

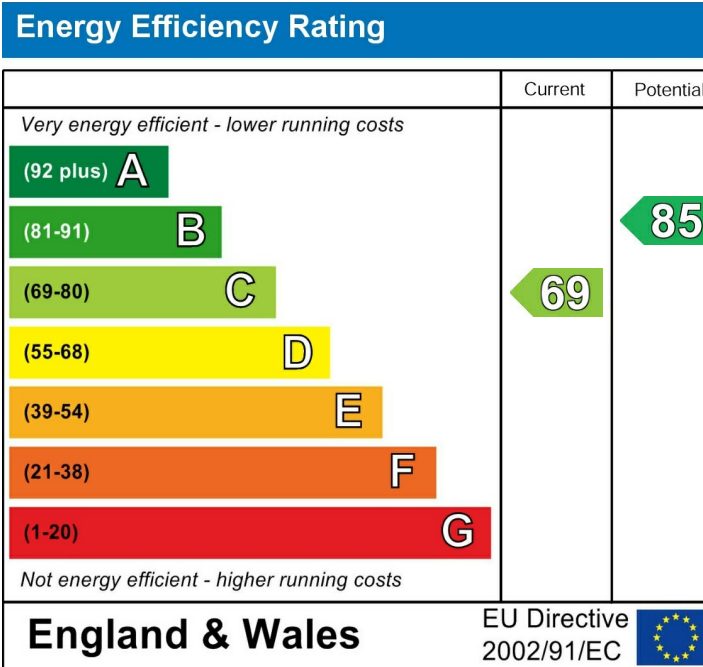

Page & Wells limited for themselves and for the vendors of this property whose agents they are give notice that: 1. These particulars do not constitute any part of, an offer or a contract. 2. All statements contained in these particulars as to this property are made without responsibility on the part of Page & Wells Limited or the Vendor. 3. None of the statements contained in these particulars as to the property is to be relied on as statements or representations of fact. 4. Any intending purchaser must satisfy himself by inspection or otherwise as to the correctness of each of the statements contained in these particulars. 5. The vendor does not make or give, and neither Page & Wells Limited nor any person in their employment has any authority to make or give any representation whatsoever in relation to this property. These particulars are supplied on the understanding that all negotiations are carried out throughout Page & Wells Limited. Properties with a reference prefixes EAA are those which Page & Wells Limited disclose an interest in accordance with the provisions of the Estates Agents Act 1979

Ground Floor

Approx. 34.3 sq. metres (368.7 sq. feet)

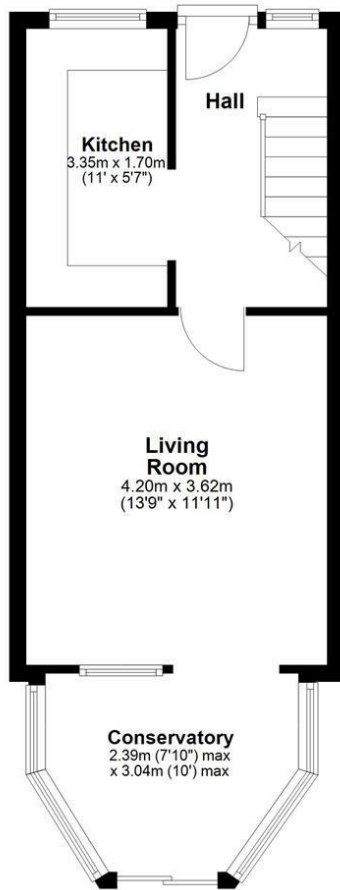

First Floor

Approx. 27.5 sq. metres (296.5 sq. feet)

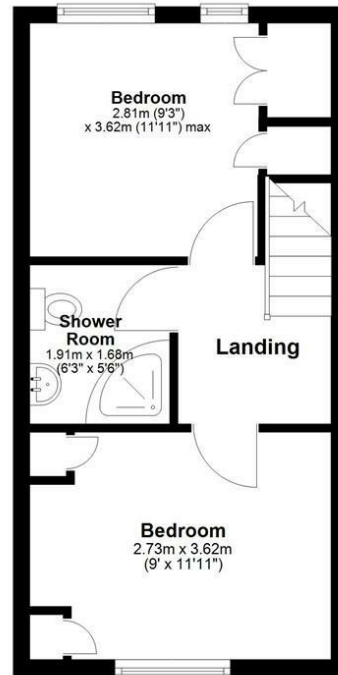

Total area: approx. 61.8 sq. metres (665.2 sq. feet)

