



**14 Fishers Road, Staplehurst, Tonbridge, TN12 0DD**  
**Offers In The Region Of £475,000**

### EXTENDED FIVE BEDROOM HOME IN THE HEART OF STAPLEHURST

Nestled in the sought-after village of Staplehurst, this beautifully extended five-bedroom home offers the perfect blend of space, convenience, and charm. Ideally located within walking distance of local shops, schools, and Staplehurst Station, you'll have easy access to frequent mainline services to London Bridge, Charing Cross, and Waterloo East.

Inside, there is an inviting entrance porch that leads into a welcoming hallway. The front lounge is cosy with an electric fireplace, while two ground-floor bedrooms and a modern shower room provide flexible living options. The real highlight of the home is the stunning open-plan kitchen, dining, and family room, complete with sky light and French doors that open onto the beautifully landscaped rear garden.

Upstairs, there are three further bedrooms and the family bathroom. The outdoor space is equally impressive, with a spacious bloc paved driveway that offers ample parking for several cars, and a neatly enclosed rear garden featuring lush lawn sections, a patio seating area, a useful store, a shed, and a charming summer house.

This fabulous home is a rare find in such a prime location. Don't miss the opportunity to make it yours. Contact Page and Wells Loose Office today to arrange your viewing today!



**ON THE GROUND FLOOR**

Entrance Porch

Entrance Hall

Lounge 16'3 x 11'8 (4.95m x 3.56m)

Kitchen/Diner 16'3 x 13'3 (4.95m x 4.04m)

Family Room 14'1 x 8'8 (4.29m x 2.64m)

Bedroom 3 16'4 x 7'10 (4.98m x 2.39m)

Bedroom 5 12'10 x 8'10 (3.91m x 2.69m)

Shower Room

**ON THE FIRST FLOOR**

Bedroom 1 16'3 x 9'8 (4.95m x 2.95m)

Bedroom 2 9 x 7'10 (2.74m x 2.39m)

Bedroom 4 7'10 x 6'11 (2.39m x 2.11m)

Family Bathroom

Externally

Driveway to Front

Neatly Enclosed Rear Garden

Summer House 6'4 x 6'4 (1.93m x 1.93m)

**Shed 6'9 x 4'8 (2.06m x 1.42m)**

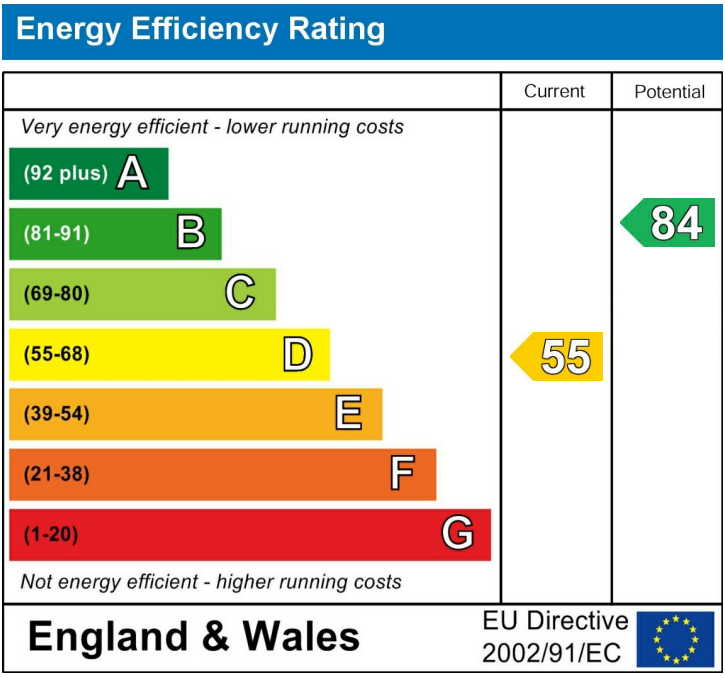

Page & Wells limited for themselves and for the vendors of this property whose agents they are give notice that: 1. These particulars do not constitute any part of, an offer or a contract. 2. All statements contained in these particulars as to this property are made without responsibility on the part of Page & Wells Limited or the Vendor. 3. None of the statements contained in these particulars as to the property is to be relied on as statements or representations of fact. 4. Any intending purchaser must satisfy himself by inspection or otherwise as to the correctness of each of the statements contained in these particulars. 5. The vendor does not make or give, and neither Page & Wells Limited nor any person in their employment has any authority to make or give any representation whatsoever in relation to this property. These particulars are supplied on the understanding that all negotiations are carried out throughout Page & Wells Limited. Properties with a reference prefixes EAA are those which Page & Wells Limited disclose an interest in accordance with the provisions of the Estates Agents Act 1979

**Fishers Road, Staplehurst, Tonbridge, Kent**  
**Approximate Gross Internal Area**  
**Main House = 1358 Sq Ft/126 Sq M**  
**Summer House & Shed = 67 Sq Ft/6 Sq M**  
**Total = 1425 Sq Ft/132 Sq M**

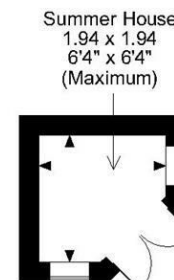
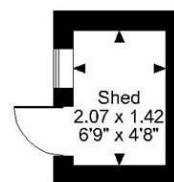
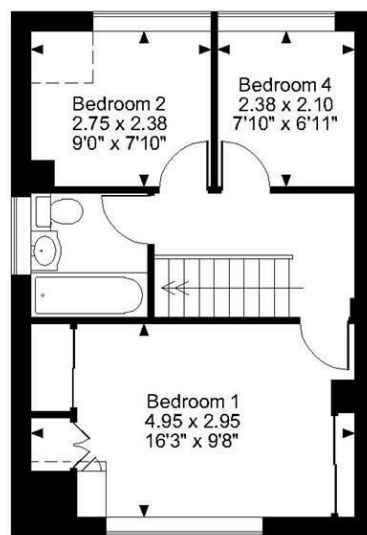
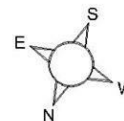

**First Floor**

**Ground Floor**

**FOR ILLUSTRATIVE PURPOSES ONLY - NOT TO SCALE**

The position & size of doors, windows, appliances and other features are approximate only.

□ □ □ □ Denotes restricted head height

© ehouse. Unauthorised reproduction prohibited. Drawing ref. dig/8615572/LCO

