



1 Boyton Court Oast Boyton Court Road, Sutton Valence, Maidstone, Kent, ME17 3BY
Price £750,000 to £750,000



CHARMING OAST HOUSE IN THE SOUGHT AFTER VILLAGE OF SUTTON VALANCE WITH WALKING DISTANCE OF POPULAR SCHOOLS

Experience countryside living with this 5 bedroom oast house in Sutton Valence, offering breath-taking views over the Weald. The ground floor features a cosy lounge/dining room in the roundel, a modern kitchen/breakfast, a ground floor cloakroom, and an integrated garage with utility space, ideal for conversion. The first floor comprises 4 double bedrooms, one of which is situated in the roundel and a shower room. The second floor offers two further generous rooms, one of which is in the roundel and a spacious family bathroom with bath and separate shower. Outside, there is off-road parking for up to 5 cars and a terrace garden with two decked seating areas with fabulous views over the Weald countryside. A shed with power and lighting, currently used as an outdoor bar, adds to the entertainment space, and a second terrace with a lawn backs onto farmland, perfect for outdoor activities.

Nestled in the picturesque village of Sutton Valence renowned for its idyllic setting surrounded by rolling hills and lush greenery. Steeped in heritage, Sutton Valence boasts an English Heritage Castle, quaint cottages, and traditional village amenities, including local shops, pubs, and community facilities. The property benefits from its close proximity to reputable schools including Sutton Valence Primary School, and Sutton Valence Preparatory School. For the commuter, the neighbouring villages of Headcorn and Staplehurst provide easy access to mainline services to London.

Don't miss out on the opportunity to view this charming family home. Call Page and Wells Loose Office today and book your viewing to avoid missing out!



GROUND FLOOR

Entrance Hall 18'0" x 11'0" (5.49m x 3.36m)

Lounge 18'5" x 18'2" (5.62m x 5.54m)

Kitchen/Dining Room 21'8" x 9'4" (6.62m x 2.86m)

FIRST FLOOR

Landing

Bedroom 1 19'0" x 18'8" (5.80m x 5.69m)

Bedroom 3 15'10" x 11'4" (4.85m x 3.47m)

Bedroom 4 14'0" x 11'0" (4.28m x 3.37m)

Bedroom 5 11'1" x 9'9" (3.40m x 2.98m)

Bathroom

SECOND FLOOR

Bedroom 2 19'1" x 19'1" (5.82m x 5.82m)

Bedroom 6 15'0" x 11'0" (4.59m x 3.37m)

Bathroom

EXTERNALLY

Garage 17'10" x 10'0" (5.45m x 3.06m)

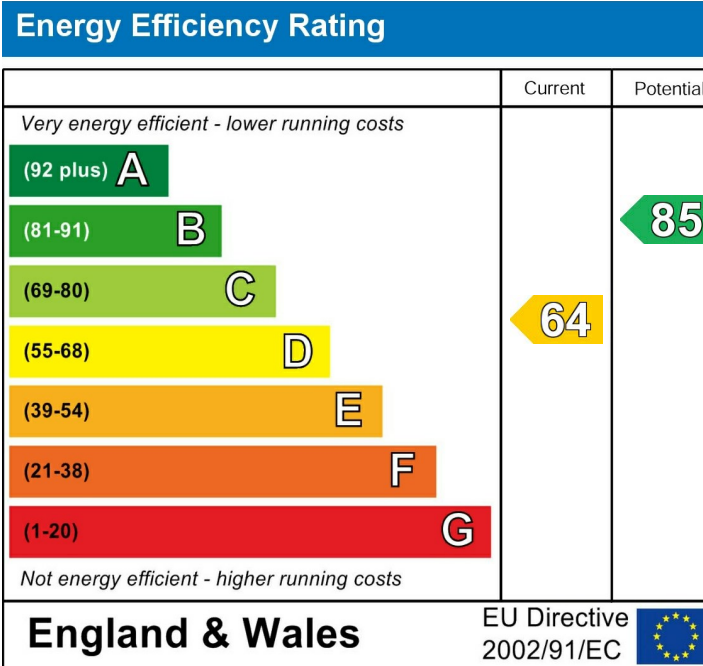

Page & Wells limited for themselves and for the vendors of this property whose agents they are give notice that: 1. These particulars do not constitute any part of, an offer or a contract. 2. All statements contained in these particulars as to this property are made without responsibility on the part of Page & Wells Limited or the Vendor. 3. None of the statements contained in these particulars as to the property is to be relied on as statements or representations of fact. 4. Any intending purchaser must satisfy himself by inspection or otherwise as to the correctness of each of the statements contained in these particulars. 5. The vendor does not make or give, and neither Page & Wells Limited nor any person in their employment has any authority to make or give any representation whatsoever in relation to this property. These particulars are supplied on the understanding that all negotiations are carried out throughout Page & Wells Limited. Properties with a reference prefixes EAA are those which Page & Wells Limited disclose an interest in accordance with the provisions of the Estates Agents Act 1979

Boyton Court Oast, Boyton Court Road, Sutton Valence, Maidstone

Approximate Gross Internal Area
 Main House = 2248 Sq Ft/209 Sq M
 Garage = 184 Sq Ft/17 Sq M
 Total = 2432 Sq Ft/226 Sq M

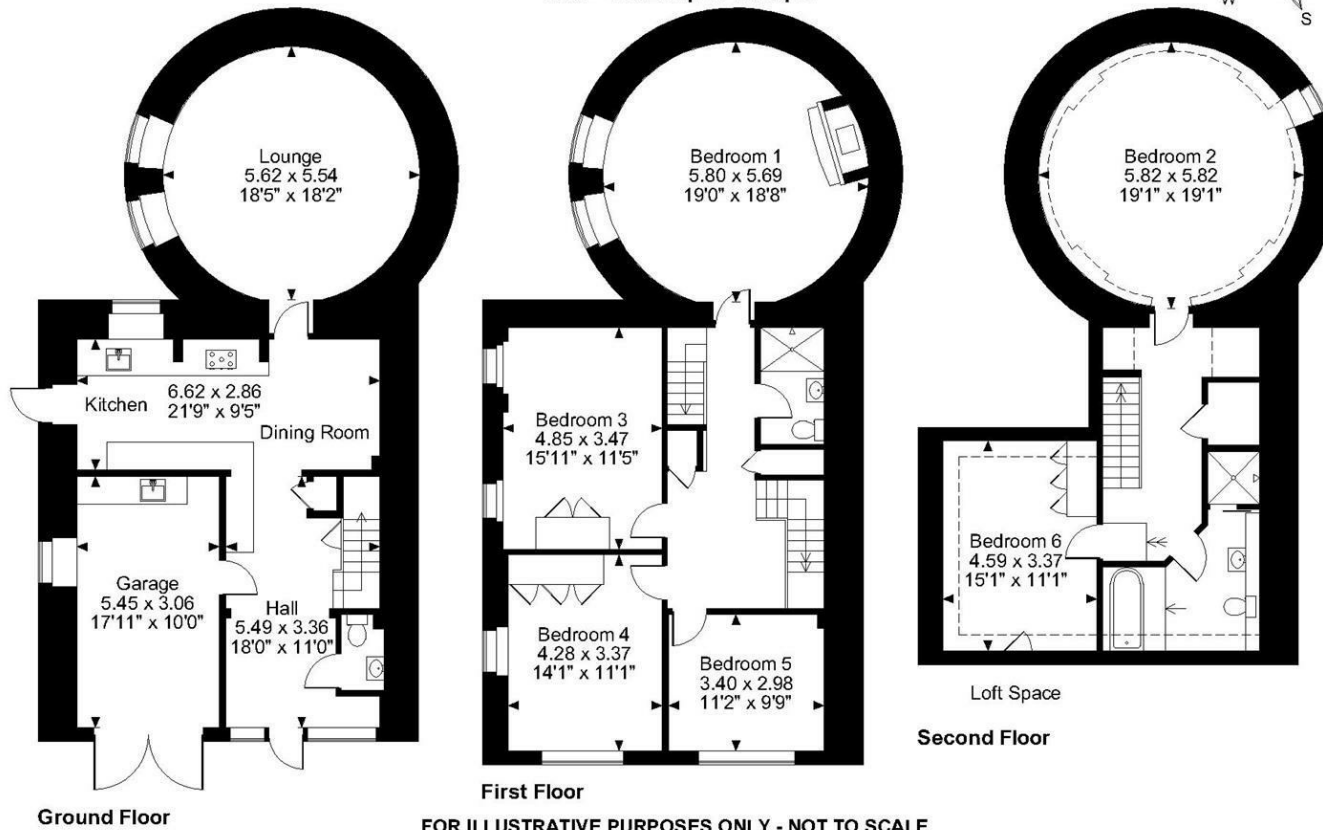
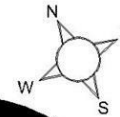

FOR ILLUSTRATIVE PURPOSES ONLY - NOT TO SCALE

The position & size of doors, windows, appliances and other features are approximate only.

--- Denotes restricted head height

© ehouse. Unauthorised reproduction prohibited. Drawing ref. dig/8551969/SS

