



Weaving Street, Weaving, Maidstone, Kent, ME14 5JN

Price £695,000



Situated in the sought-after Weaving Street in Weaving, this impressive five-bedroom semi-detached house has been thoughtfully modernised and extended and is within close proximity to the highly reputable St. Johns primary and SST & Valley secondary schools.

Approached via a spacious driveway for multiple vehicles, the home welcomes you into the entrance hall with convenient WC and cosy sitting room with a log burner which flows into a family area and bright conservatory, perfect for gatherings. The stunning modern kitchen/dining room features a partial vaulted ceiling and skylights, complemented by a convenient utility room. The ground floor also boasts a large double bedroom with an en-suite shower room and an additional lounge with bi-fold doors, offering versatility as an annexe. Upstairs are four more bedrooms, including a principal with built-in wardrobes and a second double with an en-suite, alongside two further bedrooms sharing a contemporary family bathroom.

Externally, the property features a beautifully landscaped rear garden of approximately 100 feet, complete with a garden room, patio seating area, and lush lawn, perfect for entertaining family and friends. This home is a harmonious blend of style and practicality in a desirable location. Tenure: Freehold. EPC Rating: D. Council Tax Band: E.



LOCATION

Situated in the much sought after area of Weaving, directly opposite Mote Park offering 440 acres of parkland and close to the picturesque village centre of Bearsted, where there is an attractive Green, several shops, pubs, restaurants, parish church and mainline station serving London, Ashford International and the coast. The area is also well served by excellent infant and primary schools in St. Johns, Thurnham & Roseacre and is within the catchment area of reputable grammar schools and SST secondary school.

ACCOMMODATION

Ground Floor:

Entrance Hall

Cloakroom

Sitting Room

Family Room

Conservatory

Kitchen/Dining Room

Utility Room

Bedroom

En-suite Shower Room

Lounge

First Floor:

Bedroom

Bedroom

En-suite Shower Room

Bedroom

Bedroom

Family Bathroom

EXTERNALLY

Driveway

Rear Garden

Summerhouse

Shed

VIEWING

Strictly by arrangement with the Agent's Bearsted Office, 132 Ashford Road, Bearsted, Maidstone, Kent ME14 4LX . Tel: 01622 739574.

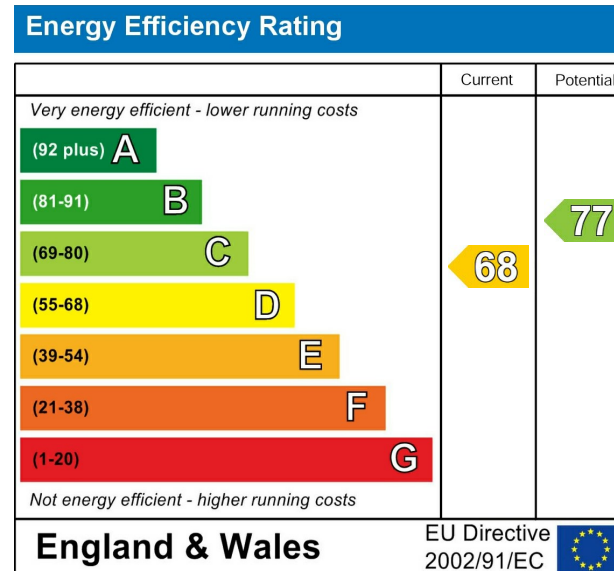

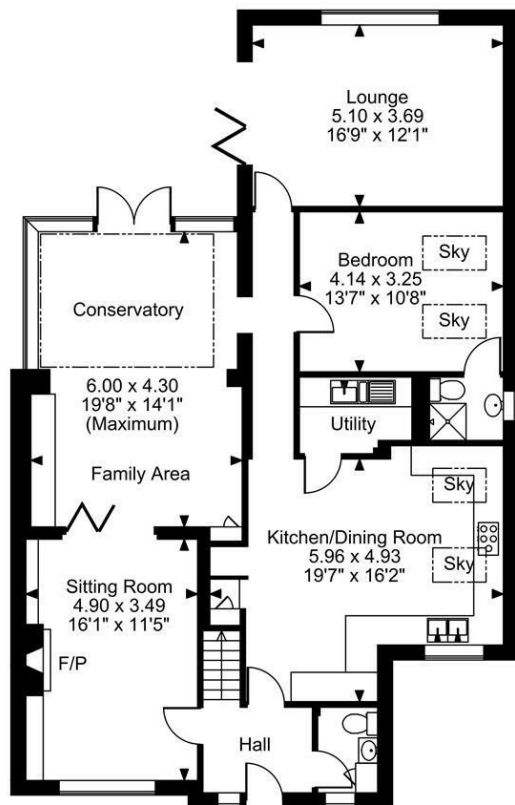

Ground Floor

Weaving Street, Weaving, Maidstone, Kent
Approximate Gross Internal Area
Main House = 1936 Sq Ft/180 Sq M
Summer House & Shed = 189 Sq Ft/18 Sq M
Total = 2125 Sq Ft/198 Sq M

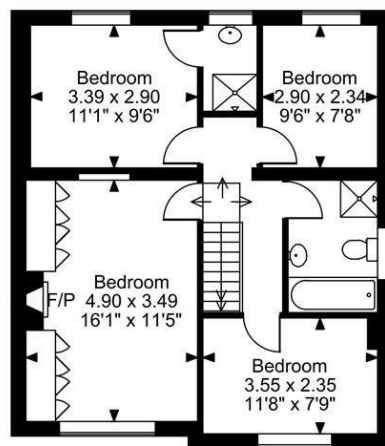
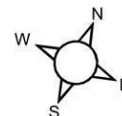

First Floor

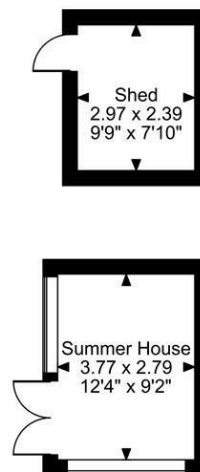

FOR ILLUSTRATIVE PURPOSES ONLY - NOT TO SCALE

The position & size of doors, windows, appliances and other features are approximate only.
 © ehouse. Unauthorised reproduction prohibited. Drawing ref. dig/8631545/SS

