



Madginford Road, Bearsted, Maidstone, , ME15 8LG

Price £400,000



**** NO FORWARD CHAIN **** Situated within the desirable Madginford development in Bearsted, this delightful semi-detached chalet-style home offers a perfect blend of comfort and convenience. Spanning an impressive 1,022 square feet, the property features three well-proportioned bedrooms, with two upstairs and another downstairs, providing versatile accommodation, making it an ideal home for families or those looking to downsize.

Upon entering, you are greeted by a welcoming entrance hall that leads to a spacious dual-aspect sitting and dining room, filled with natural light and creating a comfortable atmosphere. The kitchen is well-equipped, and there is a modern shower room for convenience, along with a convenient WC. On the upper level, you will find two bedrooms along with a separate shower, ensuring enough facilities for all.

The exterior of the property is equally appealing, with a lawned front garden adorned with established shrubs, enhancing the overall curb appeal, with an ample driveway providing parking for a minimum of two vehicles. The private rear garden, predominantly laid to lawn, offers a tranquil retreat for outdoor relaxation or entertaining guests. Tenure: Freehold. EPC Rating: Awaited. Council Tax Band: D.



LOCATION

The neighbourhood offers a variety of amenities, such as shops, a library, and schools. Just a short walk away is the charming village centre of Bearsted, which features historic buildings, beautiful green spaces, sports clubs, pubs, restaurants, a church, and a train station with London line services. Within a few minutes' walk, you can also enjoy the lovely grounds of Mote Park, while Maidstone town centre is conveniently located around 3 miles away, served by a reliable bus service.

ACCOMMODATION

Ground Floor:

Entrance Hall

Shower Room

Separate WC

Sitting/Dining Room

Kitchen

Bedroom Three

First Floor:

Bedroom One

Bedroom Two

Shower Room

EXTERNALLY

Front Garden

Driveway

Rear Garden

VIEWING

Strictly by arrangement with the Agent's Bearsted Office, 132 Ashford Road, Bearsted, Maidstone, Kent ME14 4LX. Tel: 01622 739574.

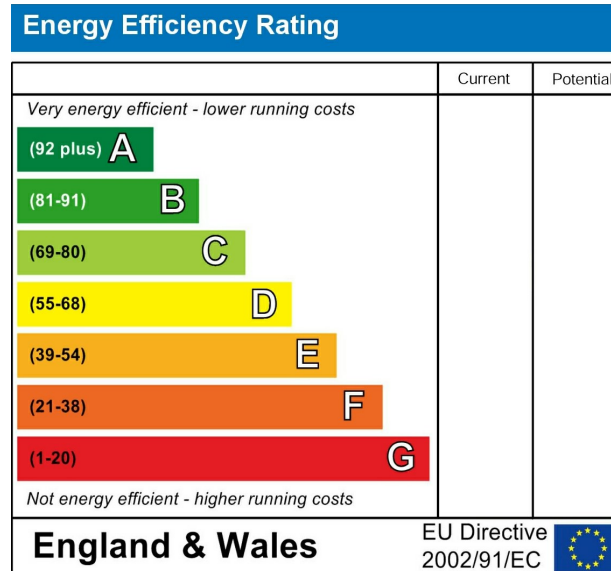

Madginford Road, Bearsted, Maidstone
Approximate Gross Internal Area
1022 Sq Ft/95 Sq M

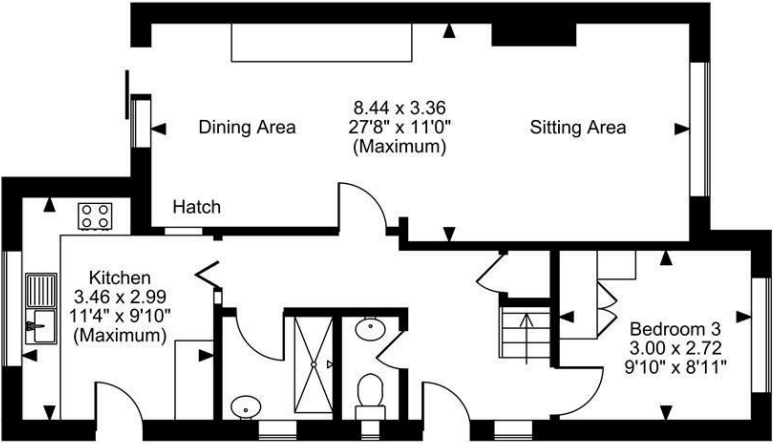
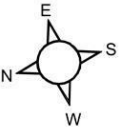

Ground Floor

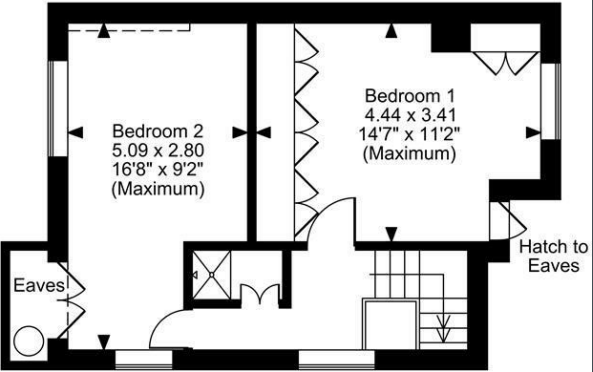

First Floor

FOR ILLUSTRATIVE PURPOSES ONLY - NOT TO SCALE

The position & size of doors, windows, appliances and other features are approximate only.

□□□ Denotes restricted head height

© ehous. Unauthorised reproduction prohibited. Drawing ref. dig/8648918/LCO

